

# CITY OF MELISSA ILA ROAD

## County Road – 277:

ROCK TO ASPHALT UPGRADE: 22 ft. Surface Width

EXTENT: ( From US 75 Service Rd. to CR – 283 ) 3.8 Mile

DISTANCE TOTALLY WITHIN COLLIN COUNTY: 2.63 Mile

DISTANCE OF MUTUAL BOUNDARY: .92 Mile

( One – Half Materials Cost Only for City of Melissa )

DISTANCE TOTALLY WITHIN CITY OF MELISSA: .25 Mile

( Total Cost of Equipment, Labor and Materials )

COST TO UPGRADE FOR CITY OF MELISSA: \$52,361.00

PROJECTED START DATE: December 2013

PROJECTED COMPLETION DATE: September 2014

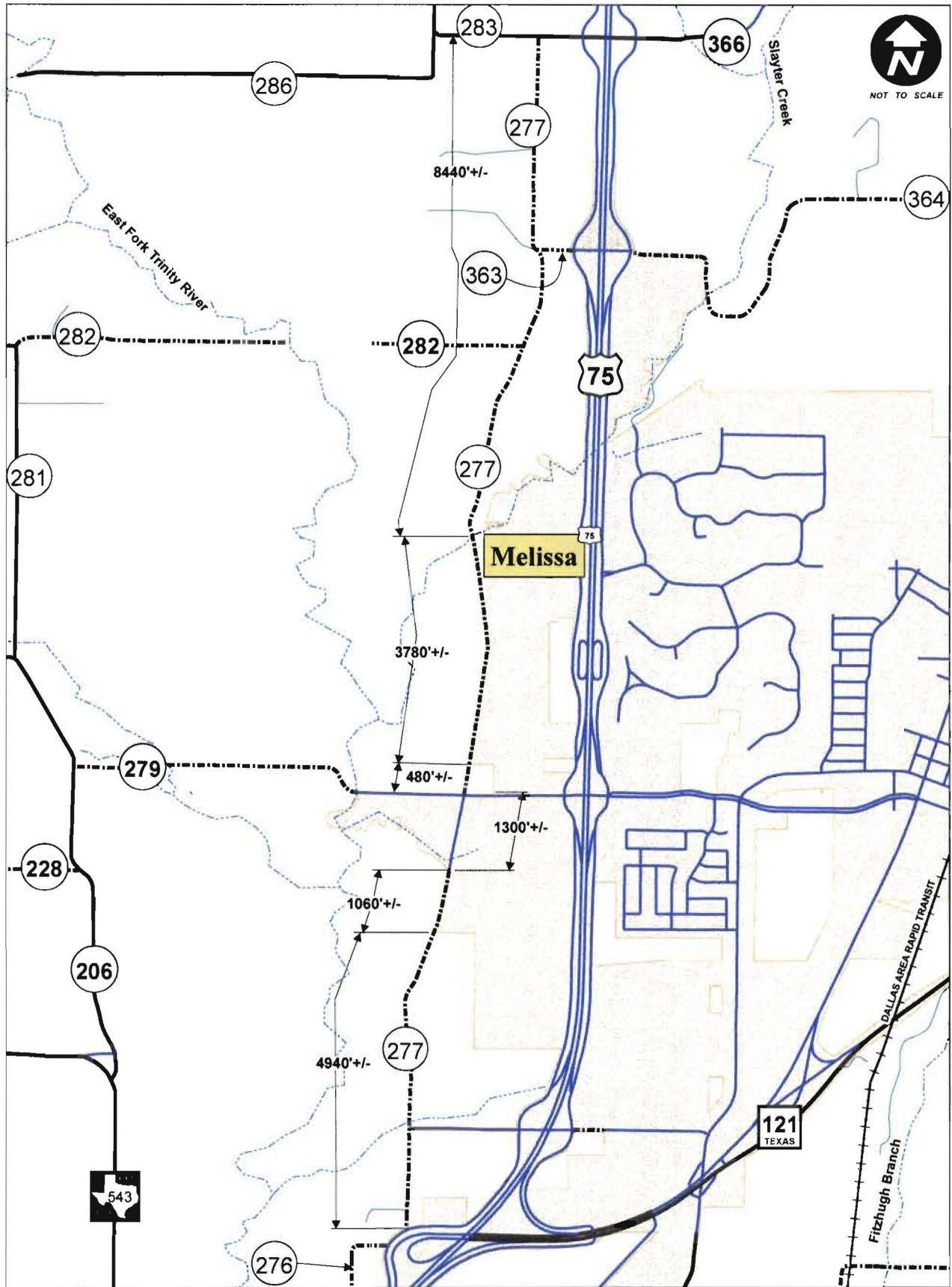

**CR 277 MUTUAL BOUNDARY ROAD 01/31/12**  
**CITY COST PARTICIPATION ROAD CITY AND COUNTY MAINTENANCE**

| LEGEND:             |  |
|---------------------|--|
| ASPHALT ROAD        |  |
| ROCK ROAD           |  |
| MELISSA CITY LIMITS |  |