

CITY OF MELISSA ILA ROAD

County Road – 279:

ROCK TO ASPHALT UPGRADE: 20 ft. Surface Width

EXTENT: (From CR – 277 west to CR – 206) 1.25 Mile

DISTANCE TOTALLY WITHIN COLLIN COUNTY: .92 Mile

DISTANCE TOTALLY WITHIN CITY OF MELISSA: .33 Mile

(From CR – 277 west to the concrete bridge)

(Total Cost of Equipment, Labor and Materials)

COST TO UPGRADE FOR THE CITY OF MELISSA: \$90,082.08

PROJECTED START DATE: January 2013

PROJECTED COMPLETION DATE: September 2014

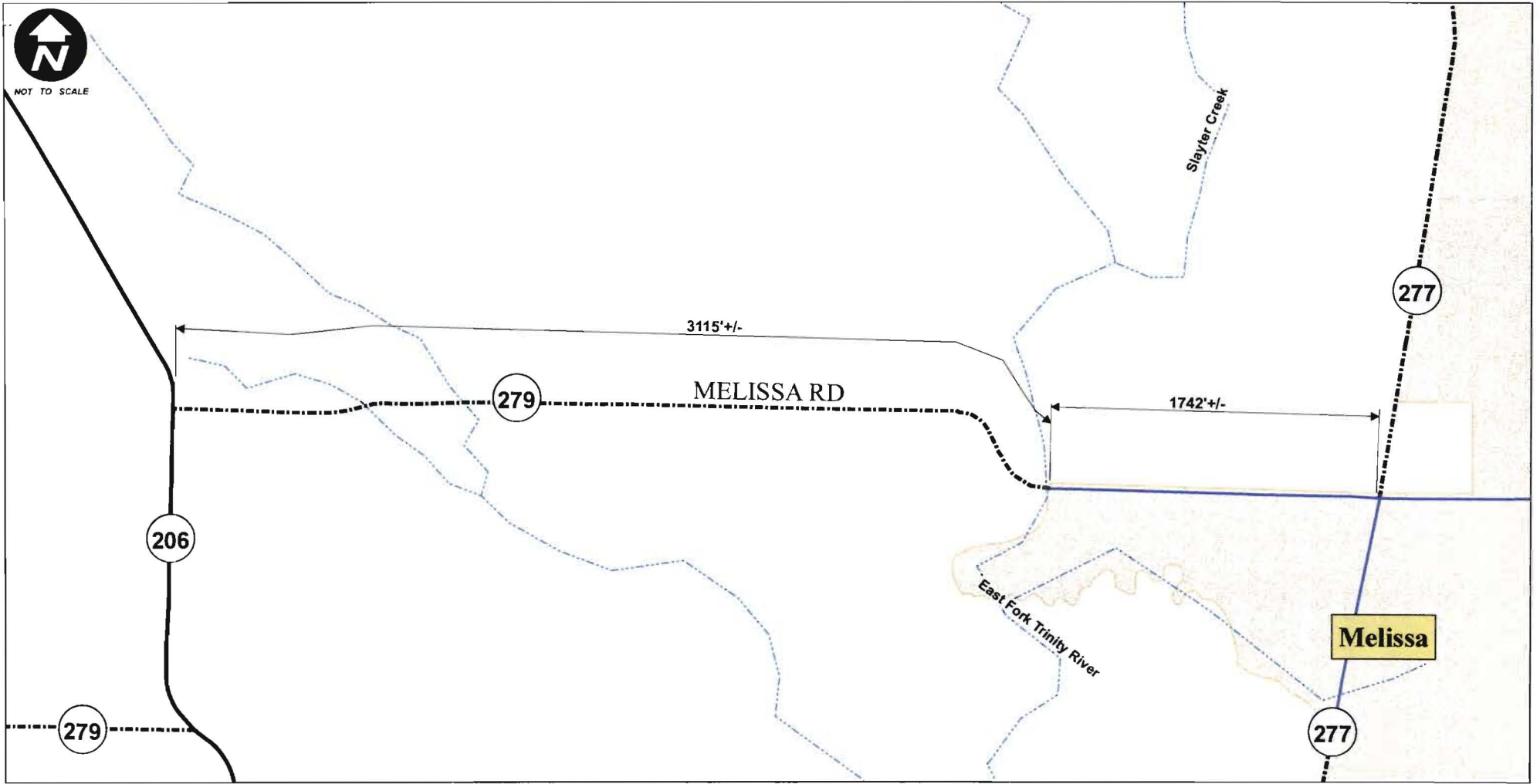

CR 279 MUTUAL BOUNDARY ROAD 01/31/12
CITY COST PARTICIPATION ROAD CITY AND COUNTY MAINTENANCE

LEGEND:	
ASPHALT ROAD	
ROCK ROAD	
MELISSA CITY LIMITS	

