

Engineering Study

Control Device: Speed Limit Signs CR 128

Roadway / Intersection: County Road 128 from CR 133 west to City Limits (approx. 6,300')

Location / Extent: Northeast of Celina (see exhibit "A")

Existing Speed Limit: 35 MPH on South end of CR 128, from FM 455 north for 0.5 miles

Existing Traffic Control: Stop Sign at intersection with FM 455

Traffic Counts: 54 Cars per day

Roadway Width/ Surface Type: 22-feet (2-Lane Asphalt)

Adjoining Land Development: Pasture/Agricultural/Residential

Roadway Design Speed: None

Visibility Along the Roadway: Good

Accident History: One major accident in the last 2 years

Radar Speed Survey Result Unable to obtain due to limited traffic at the time of the survey

Other Factors: CR 128 has recently been upgraded to asphalt and the traffic is expected to increase.

Recommendation: A 40 M.P.H. Speed Limit is recommended along the entire road.

Date: September 15, 2016

Engineer: Tracy Homfeld, P.E.





NOT TO SCALE

EXHIBIT "A"

SUBJECT LOCATION

SPEED
LIMIT
40

133

128

130

128

132

LOCATION MAP CR 128



Engineering Study

Control Device: Stop Sign CR 128

Roadway / Intersection: Intersection of CR 128 (west) with CR 133 (north and south)

Location / Extent: East Celina (see exhibit "A")

Existing Traffic Control: Speed Limit 40 MPH on CR 133

Roadway Width/ Surface Type: CR 128 – 22-feet (2-Lane Asphalt)
CR 133 North of intersection – 24-feet (2-Lane Asphalt)
CR 133 South of intersection – 24-feet (2-Lane Asphalt)

Adjoining Land Development: Pasture/Agricultural/Residential

Visibility: Trees and Hills restrict visibility south of the intersection

Accident History: None have been reported to Public Works Department

Traffic Counts: CR 128 – 47 Cars per Day
CR 133 North of the intersection – 179 Cars per Day
CR 133 South of the intersection – 189 Cars per Day

Application for Stop Sign: A Stop sign is warranted by Section 2B.04, P3, Article A of the 2011 Texas Manual on Uniform Traffic Control Devices.

Other Factors: None

Recommendation: It is recommended that a Stop Sign be placed on CR 128 at the intersection of CR 133, giving the right-of-way to the north-south traffic on CR 133.

Date: August 31, 2016

Engineer: Tracy Homfeld, PE

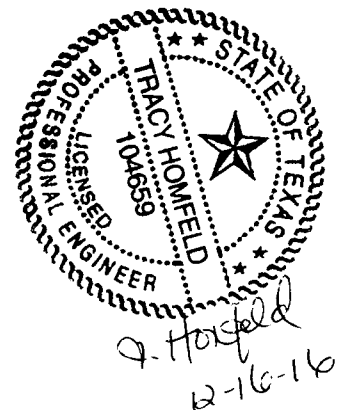

EXHIBIT "A"



SUBJECT LOCATION

COUNTY ROAD 128



COUNTY ROAD 128

133



LOCATION MAP CR 128

Engineering Study

Control Device: Stop Sign CR 132

Roadway / Intersection: Intersection of CR 132 (north) with CR 130 (east and west)

Location / Extent: East Celina (see exhibit "A")

Existing Traffic Control: Speed Limit 40 MPH on CR 132

Roadway Width/ Surface Type: CR 132 – 22-feet (2-Lane Asphalt)
CR 130 West of intersection – 24-feet (2-Lane Asphalt)
CR 130 East of intersection – 24-feet (2-Lane Asphalt)

Adjoining Land Development: Pasture/Agricultural

Visibility: Good

Accident History: None have been reported to Public Works Department

Traffic Counts: CR 132 – 106 Cars per Day
CR 130 West of the intersection – 163 Cars per Day
CR 130 East of the intersection – 158 Cars per Day

Application for Stop Sign: A Stop sign is warranted by Section 2B.04, P2, Article B & D of the 2011 Texas Manual on Uniform Traffic Control Devices.

Other Factors: None

Recommendation: It is recommended that a Stop Sign be placed on CR 132 at the intersection of CR 130, giving the right-of-way to the east-west traffic on CR 130.

Date: August 31, 2016

Engineer: Tracy Homfeld, PE



EXHIBIT "A"



COUNTY ROAD 132

SUBJECT LOCATION



COUNTY ROAD 130

WILLOW RD



LOCATION MAP CR 132

Engineering Study

Control Device: Stop Sign CR 335

Roadway / Intersection:

Intersection of CR 335 (south) with CR 331 (east and west)

Location / Extent:

Northeast McKinney (see exhibit "A")

Existing Traffic Control:

Speed Limit 45 MPH on CR 331

Roadway Width/ Surface Type:

CR 335 – 20-feet (2-Lane Asphalt)
CR 331 West of intersection – 22-feet (2-Lane Asphalt)
CR 331 East of intersection – 22-feet (2-Lane Asphalt)

Adjoining Land Development:

Pasture/Agricultural/Residential

Visibility:

Trees restrict visibility west of the intersection

Accident History:

None have been reported to Public Works Department

Traffic Counts:

CR 335 – 19 Cars per Day
CR 331 West of the intersection – 2,065 Cars per Day
CR 331 East of the intersection – 2,111 Cars per Day

Application for Stop Sign:

A Stop sign is warranted by Section 2B.04, P3, Article A of the 2011 Texas Manual on Uniform Traffic Control Devices.

Other Factors:

None

Recommendation:

It is recommended that a Stop Sign be placed on CR 335 at the intersection of CR 331, giving the right-of-way to the east-west traffic on CR 331.

Date:

August 31, 2016

Engineer:

Tracy Homfeld, PE

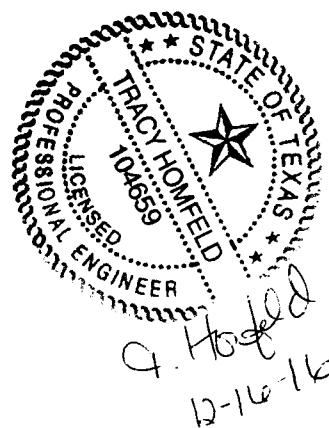

EXHIBIT "A"



COUNTY ROAD 338

COUNTY ROAD 331



SUBJECT LOCATION

COUNTY ROAD 335



LOCATION MAP CR 335

Engineering Study

Control Device: Speed Limit Signs CR 429

Roadway / Intersection: County Road 429 from CR 376 east and north to FM 3133

Location / Extent: Northeast of Anna (see exhibit "A")

Existing Speed Limit: None

Existing Traffic Control: Stop sign at intersection with FM 3133

Traffic Counts: 96 Cars per day

Roadway Width/ Surface Type: 22-feet (2-Lane Asphalt)

Adjoining Land Development: Pasture/Agricultural/Residential

Roadway Design Speed: None

Visibility Along the Roadway: Various curves and hills along road, along with many road intersections

Accident History: One accident in the past two years on rock surface

Radar Speed Survey Result Unable to obtain due to limited traffic at the time of the survey

Other Factors: CR 429 has recently been upgraded to asphalt and the traffic is expected to increase.

Recommendation: A 40 M.P.H. Speed Limit is recommended along the entire road.

Date: September 14, 2016

Engineer: Tracy Homfeld, P.E.

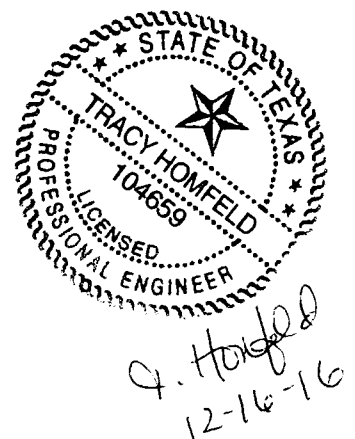

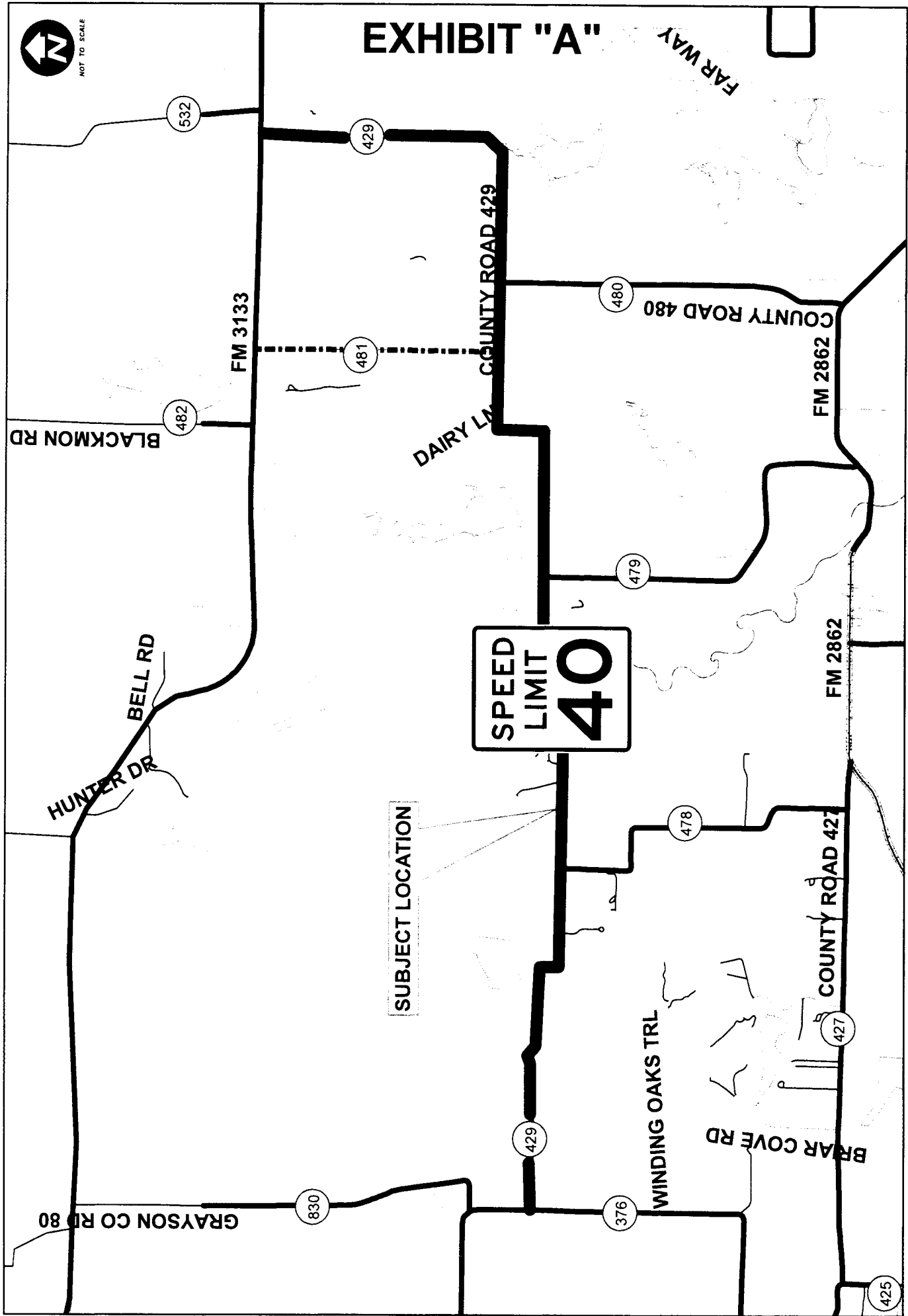

LOCATION MAP CR 429



Engineering Study

Control Device: Stop Sign CR 429

Roadway / Intersection:

Intersection of CR 429 (east) with CR 376 (north and south)

Location / Extent:

Northeast of Anna (see exhibit "A")

Existing Traffic Control:

Stop Sign on CR 429 at FM 3133

Roadway Width/ Surface Type:

CR 429 – 22-feet (2-Lane Asphalt)
CR 376 North of intersection – 24-feet (2-Lane Asphalt)
CR 376 South of intersection – 24-feet (2-Lane Asphalt)

Adjoining Land Development:

Pasture/Agricultural/Residential

Visibility:

Good

Accident History:

None have been reported to Public Works Department

Traffic Counts:

CR 429 – 72 Cars per Day
CR 376 North of the intersection – 85 Cars per Day
CR 376 South of the intersection – 78 Cars per Day

Application for Stop Sign:

A Stop sign is warranted by Section 2B.04, P2, Article D of the 2011 Texas Manual on Uniform Traffic Control Devices.

Other Factors:

None

Recommendation:

It is recommended that a Stop Sign be placed on CR 429 at the intersection of CR 376, giving the right-of-way to the north-south traffic on CR 376.

Date:

September 20, 2016

Engineer:

Tracy Homfeld, PE

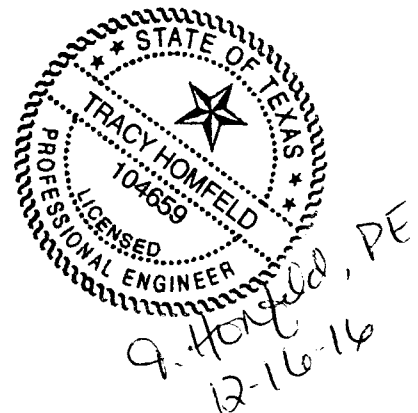
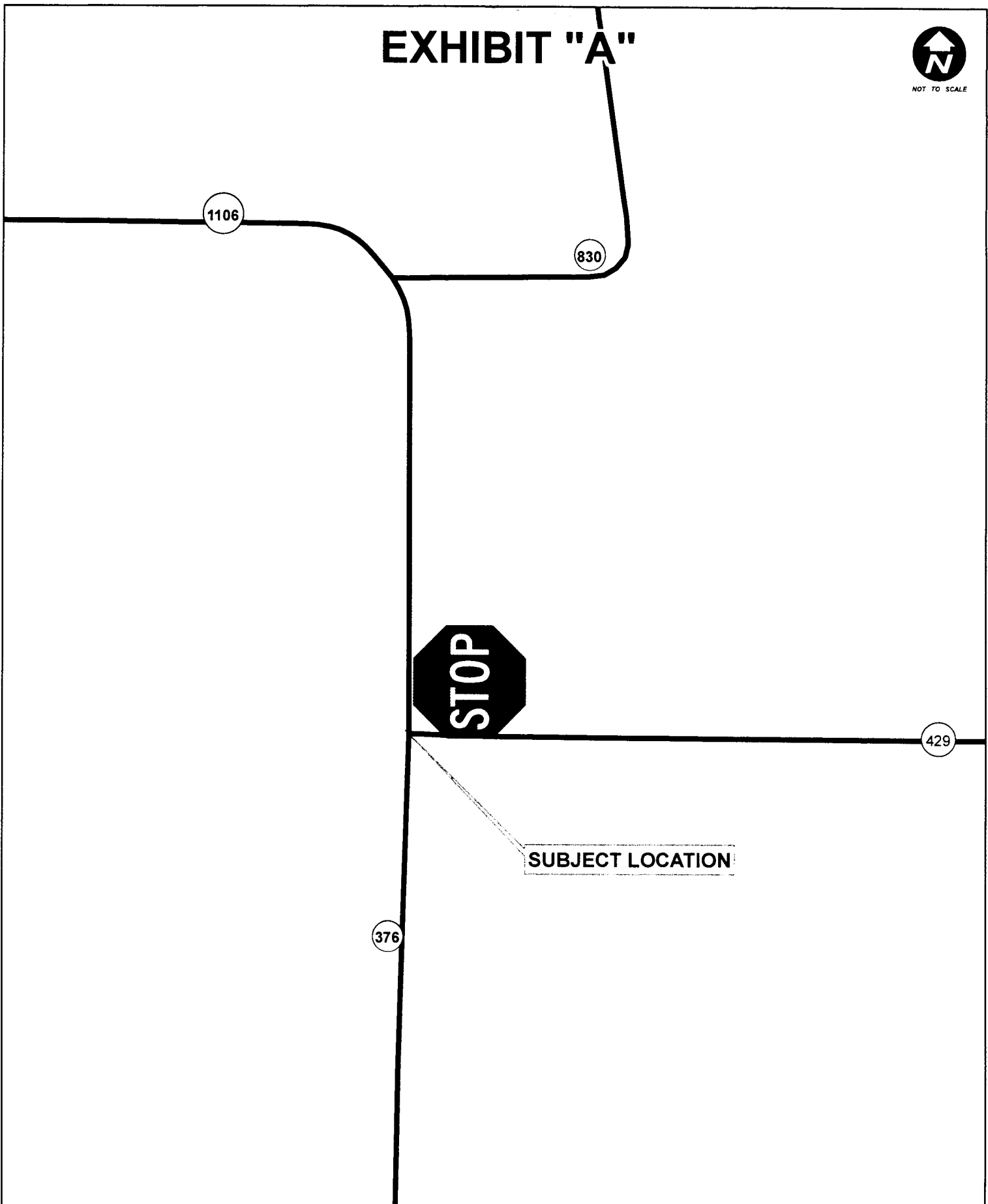

EXHIBIT "A"



LOCATION MAP CR 429

Engineering Study

Control Device: Stop Sign CR 472

Roadway / Intersection:

Intersection of CR 472 (west) with CR 475 (north and south)

Location / Extent:

East Anna (see exhibit "A")

Existing Traffic Control:

Speed Limit 40 MPH on CR 472

Roadway Width/ Surface Type:

CR 472 – 22-feet (2-Lane Asphalt)
CR 475 North of intersection – 22-feet (2-Lane Asphalt)
CR 475 South of intersection – 22-feet (2-Lane Asphalt)

Adjoining Land Development:

Pasture/Agricultural

Visibility:

Trees and curve restrict visibility to the south of the intersection

Accident History:

None have been reported to Public Works Department

Traffic Counts:

CR 472 – 315 Cars per Day
CR 475 North of the intersection – 324 Cars per Day
CR 475 South of the intersection – 38 Cars per Day

Application for Stop Sign:

A Stop sign is warranted by Section 2B.04, P2, Article B & D of the 2011 Texas Manual on Uniform Traffic Control Devices.

Other Factors:

None

Recommendation:

It is recommended that a Stop Sign be placed on CR 472 at the intersection of CR 475, giving the right-of-way to the north-south traffic on CR 475.

Date:

October 4, 2016

Engineer:

Tracy Homfeld, PE

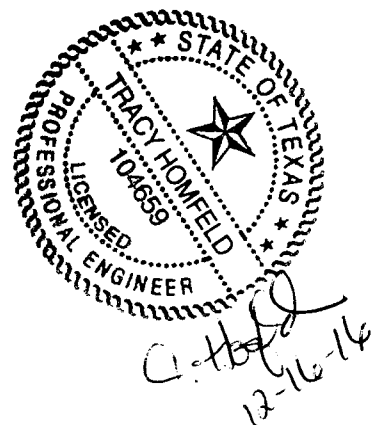
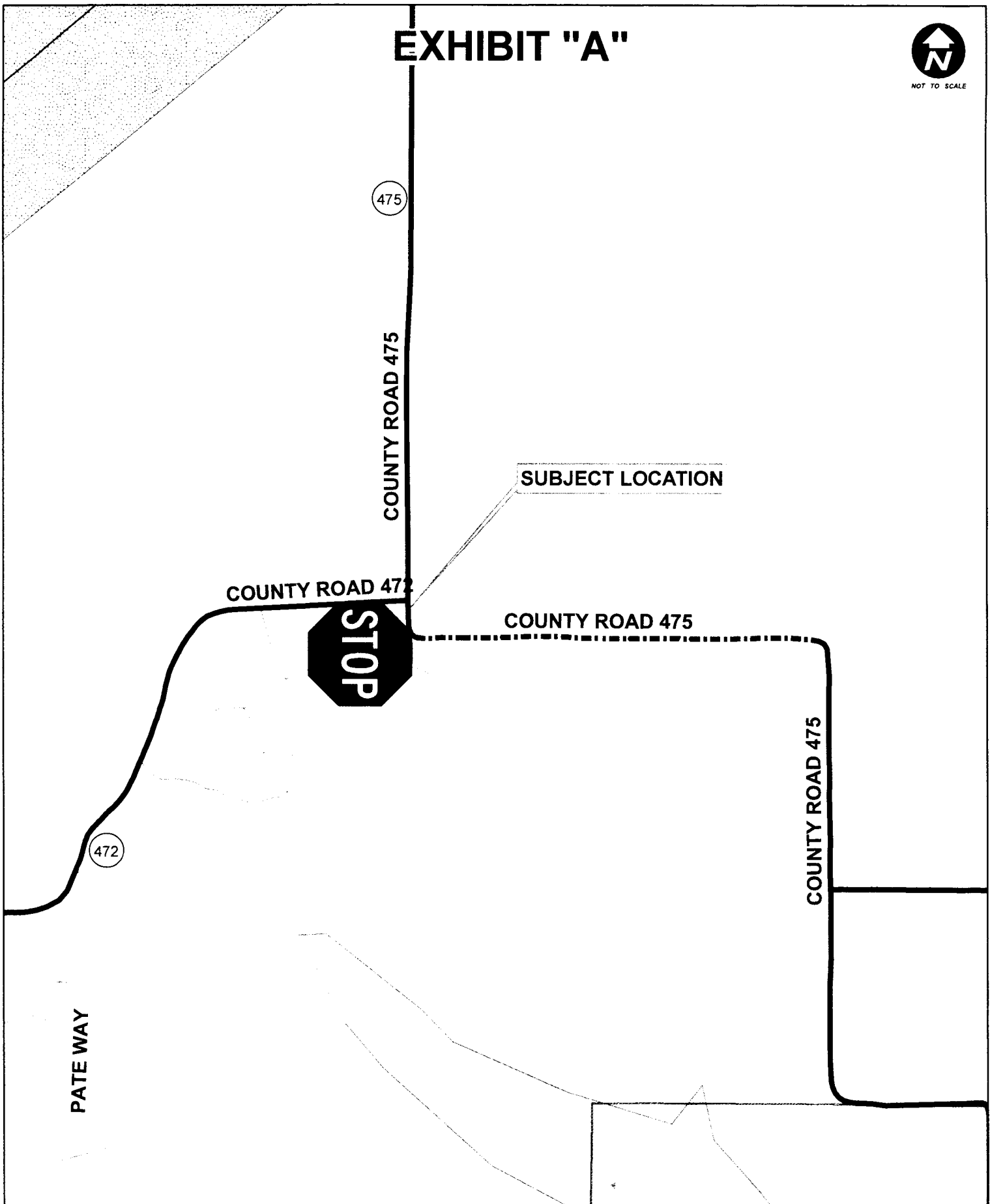

EXHIBIT "A"



LOCATION MAP CR 472

Engineering Study

Control Device: Speed Limit Signs CR 475

Roadway / Intersection: County Road 475 from FM 545 north to CR 472

Location / Extent: East of Anna (see exhibit "A")

Existing Speed Limit: 40 MPH from Highway 121 south to CR 472

Existing Traffic Control: Stop Sign at intersection with FM 545
Stop Sign at intersection with Highway 121

Traffic Counts: 30 Cars per day

Roadway Width/ Surface Type: 22-feet (2-Lane Asphalt)

Adjoining Land Development: Pasture/Agricultural/Residential

Roadway Design Speed: None

Visibility Along the Roadway: A few curves and hills restrict visibility

Accident History: No speed related accidents reported to Public Works

Radar Speed Survey Result Unable to obtain due to limited traffic at the time of the survey

Other Factors: CR 475 has recently been upgraded to asphalt and the traffic is expected to increase.

Recommendation: A 40 M.P.H. Speed Limit is recommended along the entire road.

Date: September 30, 2016

Engineer: Tracy Homfeld, P.E.



EXHIBIT "A"

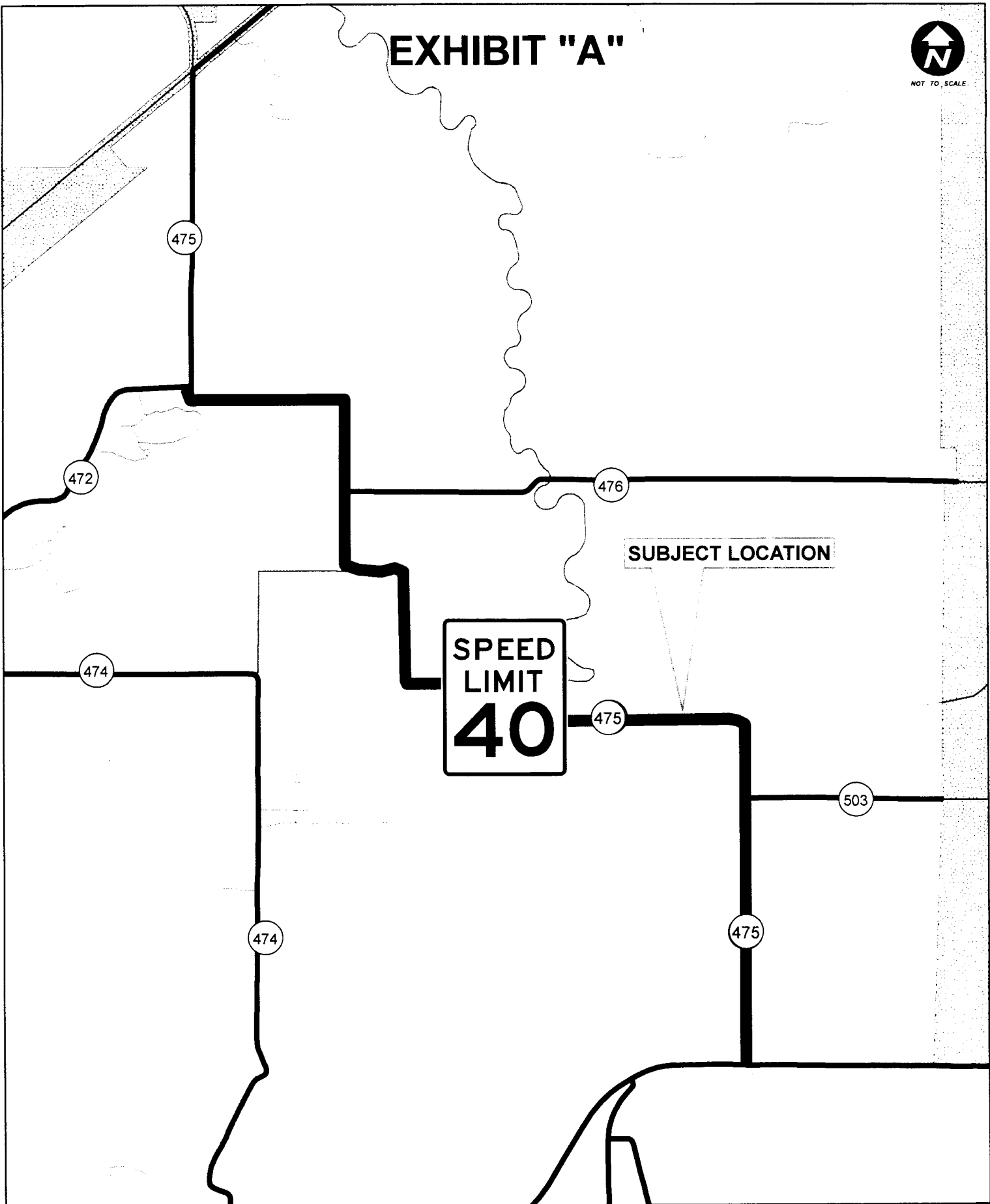

LOCATION MAP CR 475

Engineering Study

Control Device: Stop Sign CR 478

Roadway / Intersection:

Intersection of CR 478 (south) with CR 429 (east and west)

Location / Extent:

Northeast of Anna (see exhibit "A")

Existing Traffic Control:

None

Roadway Width/ Surface Type:

CR 478 – 22-feet (2-Lane Asphalt)
CR 429 East of intersection – 22-feet (2-Lane Asphalt)
CR 429 West of intersection – 22-feet (2-Lane Asphalt)

Adjoining Land Development:

Pasture/Agricultural

Visibility:

Good

Accident History:

None have been reported to Public Works Department

Traffic Counts:

CR 478 – 58 Cars per Day
CR 429 East of the intersection – 140 Cars per Day
CR 429 West of the intersection – 111 Cars per Day

Application for Stop Sign:

A Stop sign is warranted by Section 2B.04, P3, Article A of the 2011 Texas Manual on Uniform Traffic Control Devices.

Other Factors:

None

Recommendation:

It is recommended that a Stop Sign be placed on CR 478 at the intersection of CR 429, giving the right-of-way to the east-west traffic on CR 429.

Date:

September 20, 2016

Engineer:

Tracy Homfeld, PE



EXHIBIT "A"

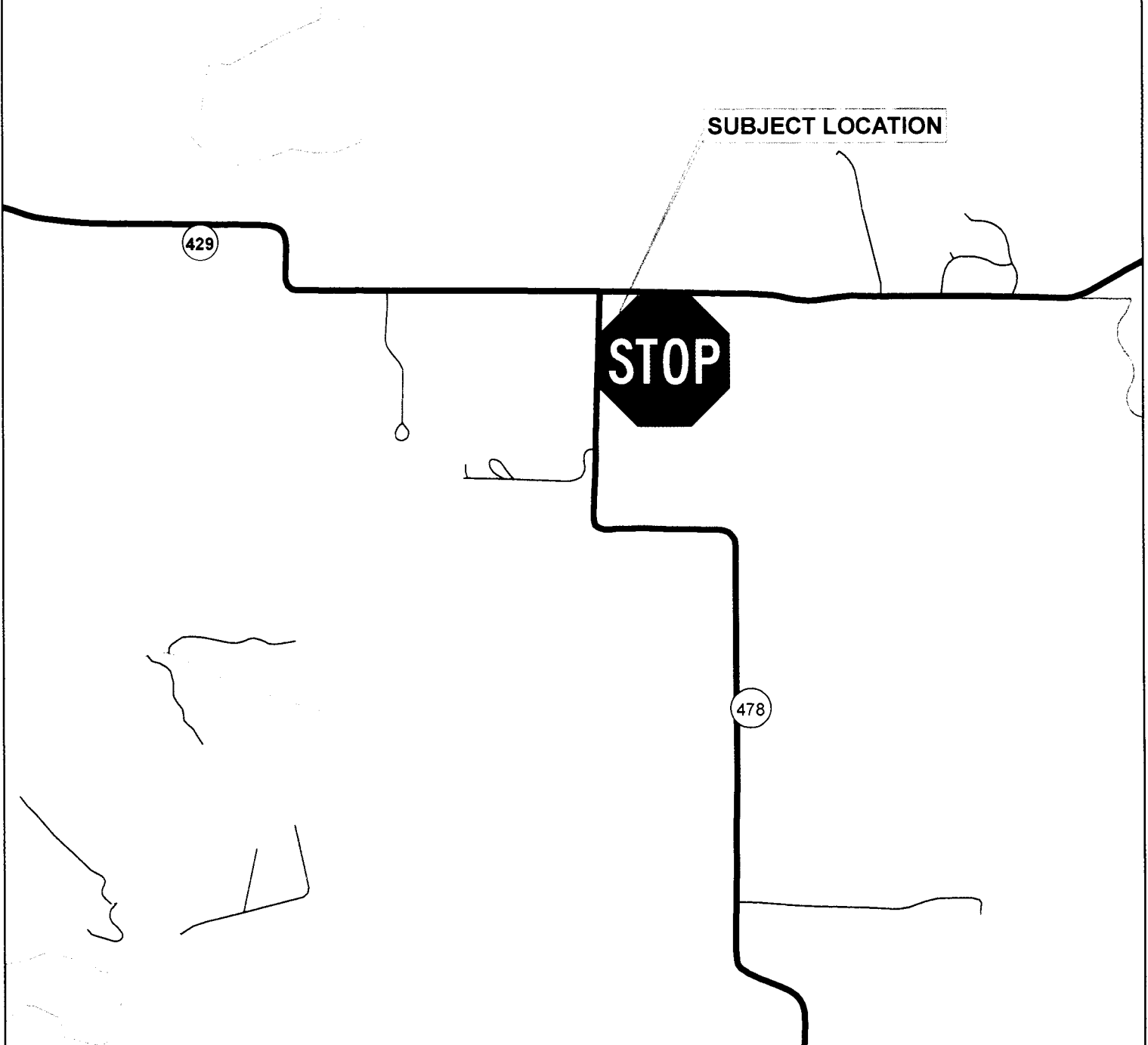

LOCATION MAP CR 478

Engineering Study

Control Device: Stop Sign CR 480

Roadway / Intersection: Intersection of CR 480 (south) with CR 429 (east and west)

Location / Extent: Northeast of Anna (see exhibit "A")

Existing Traffic Control: 40 MPH Speed Limit on CR 480

Roadway Width/ Surface Type: CR 480 – 22-feet (2-Lane Asphalt)
CR 429 East of intersection – 22-feet (2-Lane Asphalt)
CR 429 West of intersection – 22-feet (2-Lane Asphalt)

Adjoining Land Development: Pasture/Agricultural

Visibility: Trees restrict visibility to the east of the intersection.

Accident History: None have been reported to Public Works Department

Traffic Counts: CR 480 – 73 Cars per Day
CR 429 East of the intersection – 52 Cars per Day
CR 429 West of the intersection – 70 Cars per Day

Application for Stop Sign: A Stop sign is warranted by Section 2B.04, P2, Article D of the 2011 Texas Manual on Uniform Traffic Control Devices.

Other Factors: None

Recommendation: It is recommended that a Stop Sign be placed on CR 480 at the intersection of CR 429, giving the right-of-way to the east-west traffic on CR 429.

Date: September 20, 2016

Engineer: Tracy Homfeld, PE



EXHIBIT "A"



481

429

SUBJECT LOCATION



480



LOCATION MAP CR 480

Engineering Study

Control Device: Stop Sign CR 503

Roadway / Intersection: Intersection of CR 503 (east) with CR 475 (north and south)

Location / Extent: East Anna (see exhibit "A")

Existing Traffic Control: Stop sign on CR 503 with FM 2862

Roadway Width/ Surface Type: CR 503 – 26-feet (2-Lane Asphalt)
CR 475 North of intersection – 22-feet (2-Lane Asphalt)
CR 475 South of intersection – 22-feet (2-Lane Asphalt)

Adjoining Land Development: Pasture/Agricultural

Visibility: Trees and a hill restrict visibility to the south of the intersection.

Accident History: None have been reported to Public Works Department

Traffic Counts: CR 503 – 14 Cars per Day
CR 475 North of the intersection – 20 Cars per Day
CR 475 South of the intersection – 31 Cars per Day

Application for Stop Sign: A Stop sign is warranted by Section 2B.04, P3, Article A of the 2011 Texas Manual on Uniform Traffic Control Devices.

Other Factors: None

Recommendation: It is recommended that a Stop Sign be placed on CR 503 at the intersection of CR 475, giving the right-of-way to the north-south traffic on CR 475.

Date: October 4, 2016

Engineer: Tracy Homfeld, PE



EXHIBIT "A"

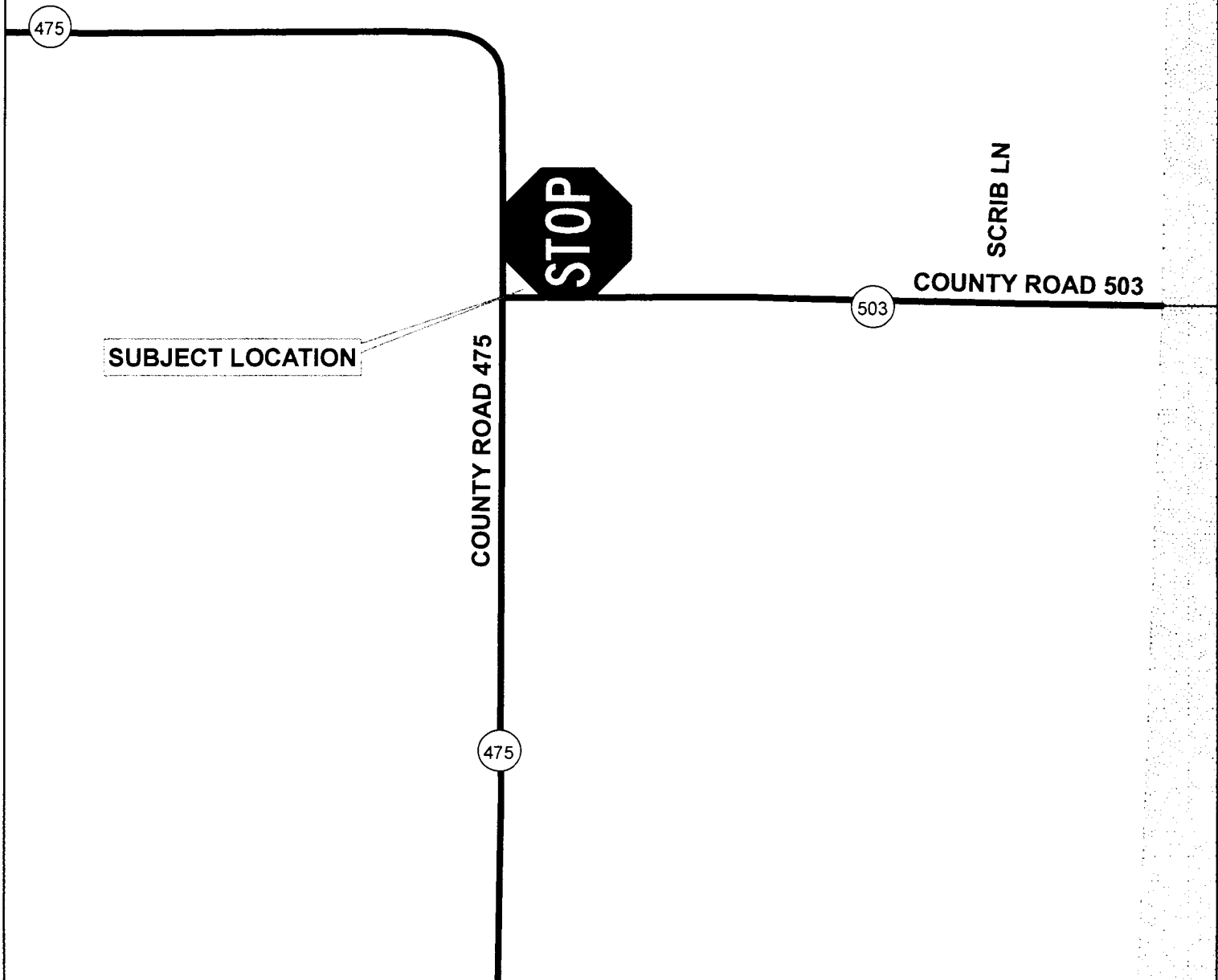

LOCATION MAP CR 503

Engineering Study

Control Device: Stop Sign CR 565

Roadway / Intersection: Intersection of CR 565 (west) with CR 613 (north and south)

Location / Extent: Northwest of Farmersville (see exhibit "A")

Existing Traffic Control: Speed Limit 40 MPH on CR 613

Roadway Width/ Surface Type: CR 565 – 22-feet (2-Lane Asphalt)
CR 613 North of intersection – 24-feet (2-Lane Asphalt)
CR 613 South of intersection – 24-feet (2-Lane Asphalt)

Adjoining Land Development: Pasture/Agricultural/Residential

Visibility: Good

Accident History: None have been reported to Public Works Department

Traffic Counts: CR 565 – 184 Cars per Day
CR 613 North of the intersection – 103 Cars per Day
CR 613 South of the intersection – 209 Cars per Day

Application for Stop Sign: A Stop sign is warranted by Section 2B.04, P2, Article B & D of the 2011 Texas Manual on Uniform Traffic Control Devices.

Other Factors: None

Recommendation: It is recommended that a Stop Sign be placed on CR 565 at the intersection of CR 613, giving the right-of-way to the north-south traffic on CR 613.

Date: August 31, 2016

Engineer: Tracy Homfeld, PE



EXHIBIT "A"



613

COUNTY ROAD 613

SUBJECT LOCATION



565

COUNTY ROAD 565

MARY ANN RD

613

MARY ANN RD
BRINEGAR RD



LOCATION MAP CR 565

Engineering Study

Control Device: Stop Sign CR 565

Roadway / Intersection: Intersection of CR 565 (west) with CR 610 (south) and CR 565 (north)

Location / Extent: Northwest of Farmersville (see exhibit "A")

Existing Traffic Control: None

Roadway Width/ Surface Type: CR 565 – 22-feet (2-Lane Asphalt)
CR 565 North of intersection – 22-feet (2-Lane Asphalt)
CR 610 South of intersection – 24-feet (2-Lane Asphalt)

Adjoining Land Development: Pasture/Agricultural/Residential

Visibility: Good

Accident History: None have been reported to Public Works Department

Traffic Counts: CR 565 – 58 Cars per Day
CR 565 North of the intersection – 184 Cars per Day
CR 610 South of the intersection – 123 Cars per Day

Application for Stop Sign: A Stop sign is warranted by Section 2B.04, P2, Article B & D of the 2011 Texas Manual on Uniform Traffic Control Devices.

Other Factors: None

Recommendation: It is recommended that a Stop Sign be placed on CR 565 at the intersection of CR 610 and CR 565, giving the right-of-way to the north-south traffic on CR 610 and CR 565.

Date: August 31, 2016

Engineer: Tracy Homfeld, PE

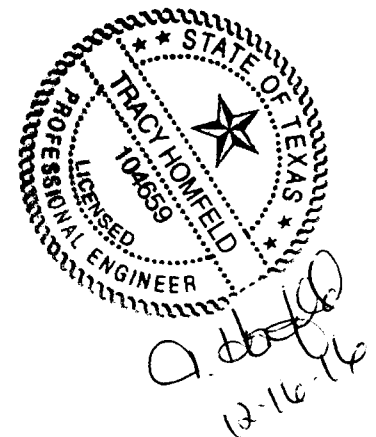

EXHIBIT "A"



SUBJECT LOCATION

COUNTY ROAD 565



COUNTY ROAD 610

565

610



LOCATION MAP CR 565

Engineering Study

Control Device: Speed Limit Signs CR 565

Roadway / Intersection: County Road 565 from CR 613 west to end

Location / Extent: Northwest of Farmersville (see exhibit "A")

Existing Speed Limit: None

Existing Traffic Control: None

Traffic Counts: 184 Cars per day

Roadway Width/ Surface Type: 22-feet (2-Lane Asphalt)

Adjoining Land Development: Pasture/Agricultural/Residential

Roadway Design Speed: None

Visibility Along the Roadway: A few curves along the road that restrict sight distance

Accident History: No speed related accidents reported to Public Works

Radar Speed Survey Result Unable to obtain due to limited traffic at the time of the survey

Other Factors: CR 565 has recently been upgraded to asphalt and the traffic is expected to increase.

Recommendation: A 40 M.P.H. Speed Limit is recommended along the entire road.

Date: September 15, 2016

Engineer: Tracy Homfeld, P.E.





NOT TO SCALE

EXHIBIT "A"

SUBJECT LOCATION

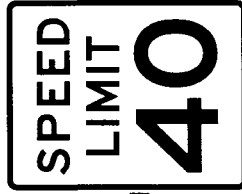

613

613

610

565

LOCATION MAP CR 565



Engineering Study

Control Device: Speed Limit Signs CR 610

Roadway / Intersection: County Road 610 from CR 567 north to CR 565

Location / Extent: Northwest of Farmersville (see exhibit "A")

Existing Speed Limit: None

Existing Traffic Control: None

Traffic Counts: 96 Cars per day

Roadway Width/ Surface Type: 24-feet (2-Lane Asphalt)

Adjoining Land Development: Pasture/Agricultural/Residential

Roadway Design Speed: None

Visibility Along the Roadway: Various curves and hills along road

Accident History: No speed related accidents reported to Public Works

Radar Speed Survey Result Unable to obtain due to limited traffic at the time of the survey

Other Factors: CR 610 has recently been upgraded to asphalt and the traffic is expected to increase.

Recommendation: A 40 M.P.H. Speed Limit is recommended along the entire road.

Date: September 14, 2016

Engineer: Tracy Homfeld, P.E.



EXHIBIT "A"

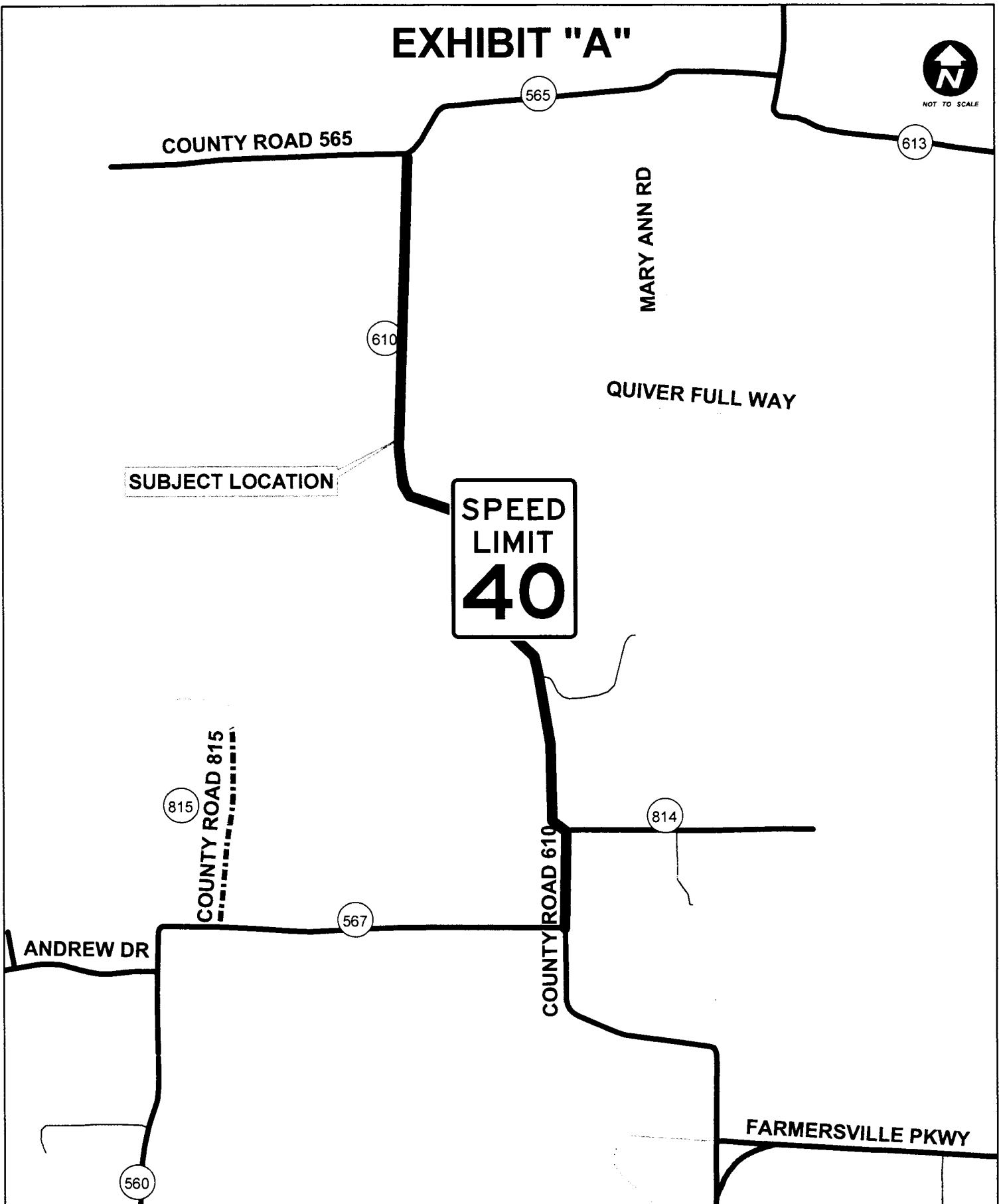

LOCATION MAP CR 610

Engineering Study

Control Device: Stop Sign CR 645

Roadway / Intersection: Intersection of CR 645 (south) with CR 605 (east and west)

Location / Extent: South of Farmersville (see exhibit "A")

Existing Traffic Control: Speed Limit 45 MPH on CR 645

Roadway Width/ Surface Type: CR 645 – 24-feet (2-Lane Asphalt)
CR 605 West of intersection – 23-feet (2-Lane Asphalt)
CR 605 East of intersection – 23-feet (2-Lane Asphalt)

Adjoining Land Development: Pasture/Agricultural/Residential

Visibility: Good

Accident History: None have been reported to Public Works Department

Traffic Counts: CR 645 – 313 Cars per Day
CR 605 West of the intersection – 194 Cars per Day
CR 605 East of the intersection – 316 Cars per Day

Application for Stop Sign: A Stop sign is warranted by Section 2B.04, P2, Article B & D of the 2011 Texas Manual on Uniform Traffic Control Devices.

Other Factors: None

Recommendation: It is recommended that a Stop Sign be placed on CR 645 at the intersection of CR 605, giving the right-of-way to the east-west traffic on CR 605.

Date: December 16, 2016

Engineer: Tracy Homfeld, PE

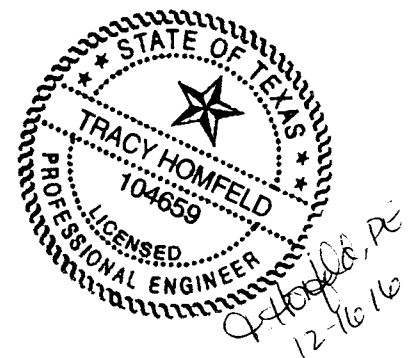

EXHIBIT "A"



OLD JOSEPHINE RD

605

COUNTY ROAD 605

COUNTY ROAD 648

STOP

SUBJECT LOCATION

COUNTY ROAD 645

MAITLAND WAY



LOCATION MAP CR 645

Engineering Study

Control Device: Stop Sign CR 645

Roadway / Intersection: Intersection of CR 645 (north) with CR 643 (east and west)

Location / Extent: South of Farmersville (see exhibit "A")

Existing Traffic Control: Speed Limit 45 MPH on CR 645

Roadway Width/ Surface Type: CR 645 – 24-feet (2-Lane Asphalt)
CR 643 West of intersection – 24-feet (2-Lane Asphalt)
CR 643 East of intersection – 24-feet (2-Lane Asphalt)

Adjoining Land Development: Pasture/Agricultural

Visibility: Good

Accident History: None have been reported to Public Works Department

Traffic Counts: CR 645 – 159 Cars per Day
CR 643 West of the intersection – 197 Cars per Day
CR 643 East of the intersection – 188 Cars per Day

Application for Stop Sign: A Stop sign is warranted by Section 2B.04, P2, Article B & D of the 2011 Texas Manual on Uniform Traffic Control Devices.

Other Factors: None

Recommendation: It is recommended that a Stop Sign be placed on CR 645 at the intersection of CR 643, giving the right-of-way to the east-west traffic on CR 643.

Date: December 16, 2016

Engineer: Tracy Homfeld, PE

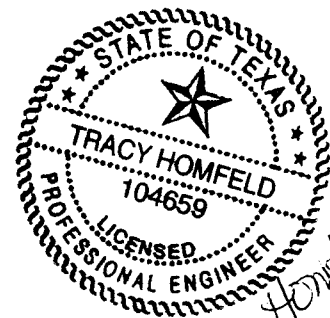

Tracy Homfeld, PE
12-16-16

EXHIBIT "A"



COUNTY ROAD 646

COUNTY ROAD 645



COUNTY ROAD 643

643

TOWER CIR

SUBJECT LOCATION



LOCATION MAP CR 645

Engineering Study

Control Device: Stop Sign CR 814

Roadway / Intersection: Intersection of CR 814 (east) with CR 610 (north and south)

Location / Extent: Northwest of Farmersville (see exhibit "A")

Existing Traffic Control: None

Roadway Width/ Surface Type: CR 814 – 18-feet (2-Lane Asphalt)
CR 610 North of intersection – 24-feet (2-Lane Asphalt)
CR 610 South of intersection – 24-feet (2-Lane Asphalt)

Adjoining Land Development: Pasture/Agricultural

Visibility: Curve north of intersection restricts visibility

Accident History: None have been reported to Public Works Department

Traffic Counts: CR 814 – 106 Cars per Day
CR 610 North of the intersection – 120 Cars per Day
CR 610 South of the intersection – 185 Cars per Day

Application for Stop Sign: A Stop sign is warranted by Section 2B.04, P2, Article D of the 2011 Texas Manual on Uniform Traffic Control Devices.

Other Factors: None

Recommendation: It is recommended that a Stop Sign be placed on CR 814 at the intersection of CR 610, giving the right-of-way to the north-south traffic on CR 610.

Date: September 20, 2016

Engineer: Tracy Homfeld, PE



EXHIBIT "A"

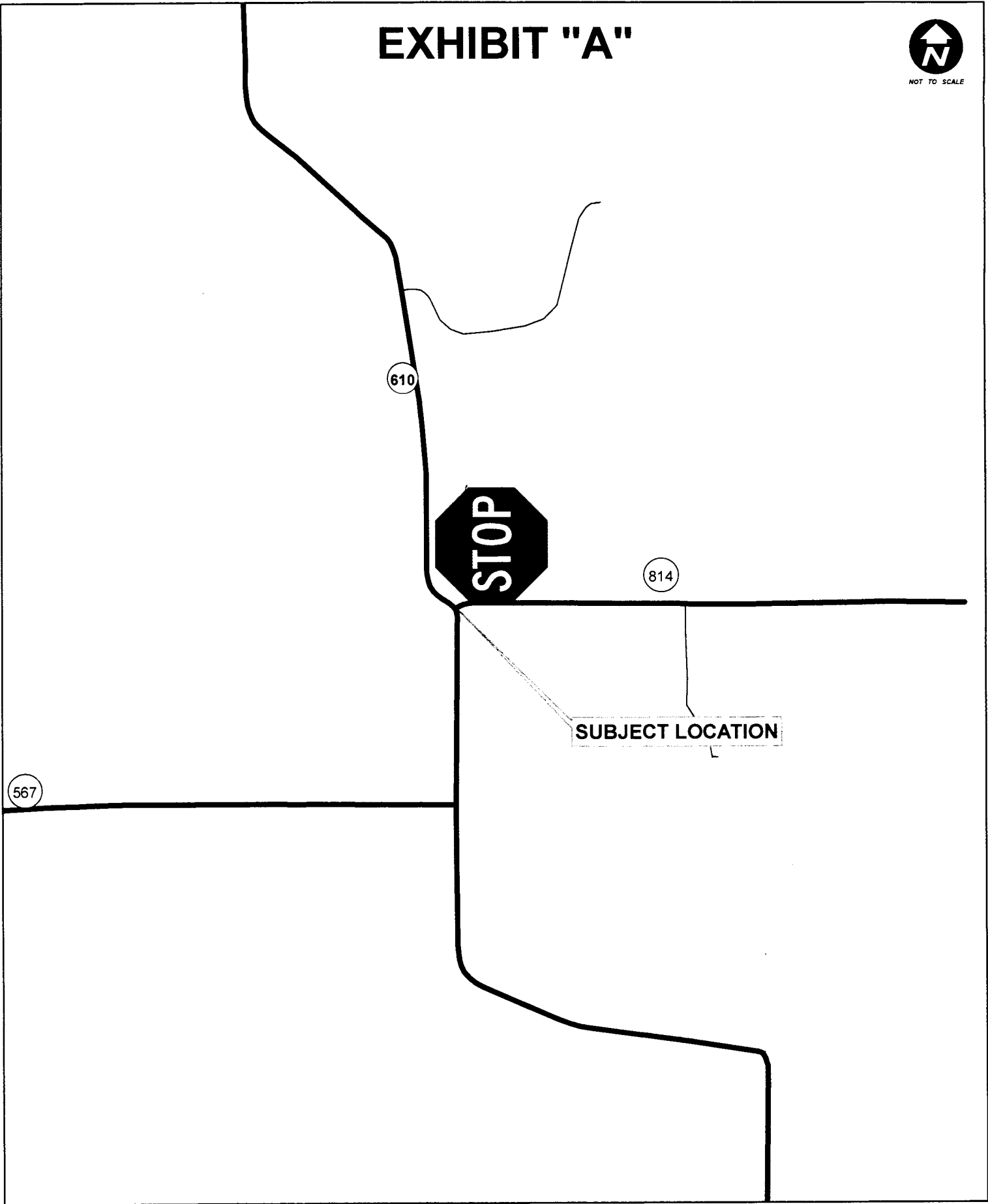

LOCATION MAP CR 814

Engineering Study

Control Device: Speed Limit Signs CR 476

<u>Roadway / Intersection:</u>	County Road 476 from CR 475 east to city limits (approx. 6,900')
<u>Location / Extent:</u>	East of Anna (see exhibit "A")
<u>Existing Speed Limit:</u>	None
<u>Existing Traffic Control:</u>	Stop Sign at intersection with FM 2862
<u>Traffic Counts:</u>	30 Cars per day
<u>Roadway Width/ Surface Type:</u>	24-feet (2-Lane Asphalt)
<u>Adjoining Land Development:</u>	Pasture/Agricultural
<u>Roadway Design Speed:</u>	None
<u>Visibility Along the Roadway:</u>	A few curves and hills restrict visibility
<u>Accident History:</u>	No speed related accidents reported to Public Works
<u>Radar Speed Survey Result</u>	Unable to obtain due to limited traffic at the time of the survey
<u>Other Factors:</u>	CR 476 has recently been upgraded to asphalt and the traffic is expected to increase.
<u>Recommendation:</u>	A 40 M.P.H. Speed Limit is recommended along the entire road.
<u>Date:</u>	September 30, 2016
<u>Engineer:</u>	Tracy Homfeld, P.E.

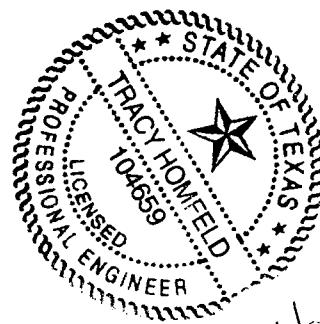

Tracy Homfeld
12-16-16

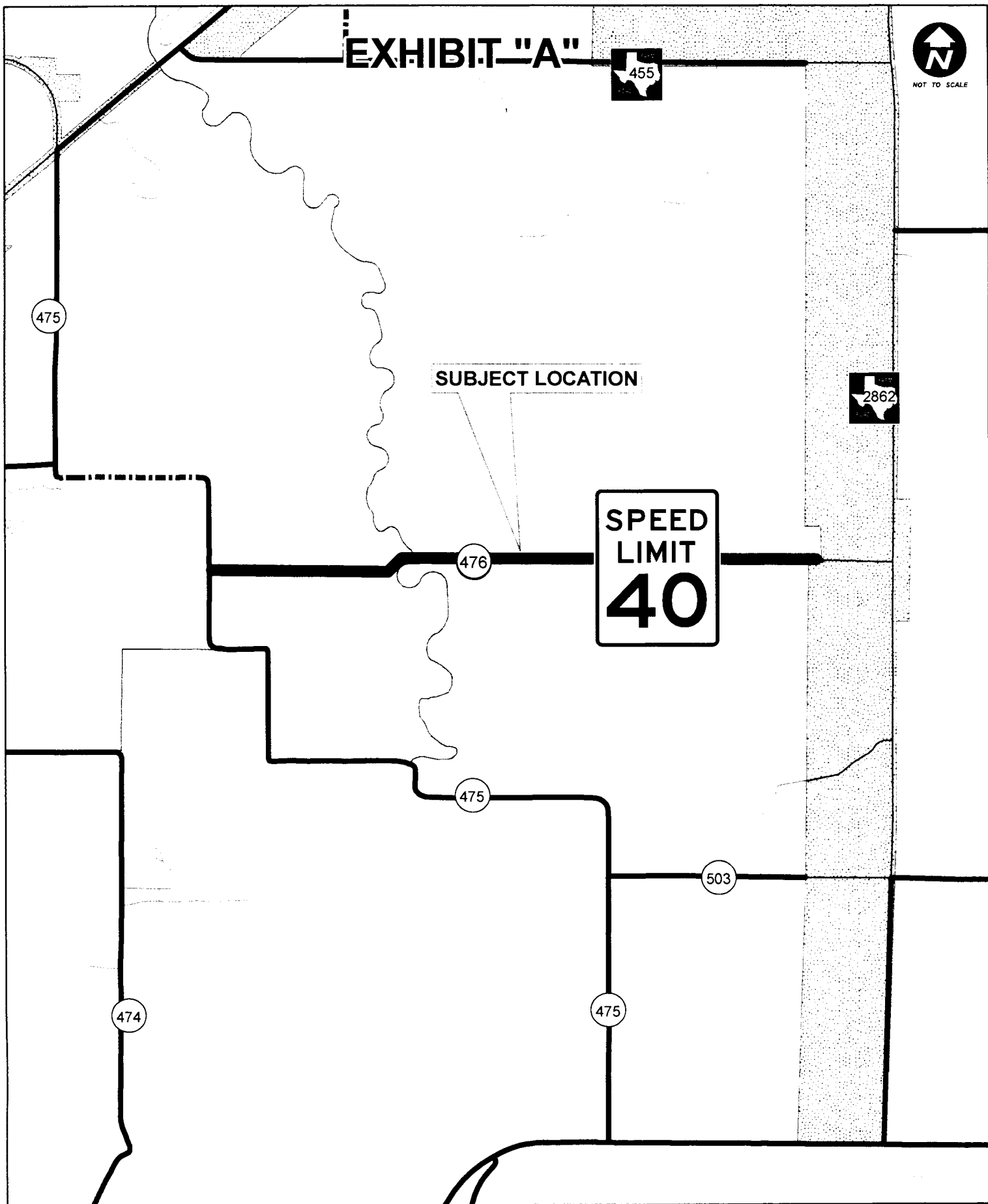

LOCATION MAP CR 476

Engineering Study

Control Device: Stop Sign CR 476

Roadway / Intersection: Intersection of CR 476 (east) with CR 475 (north and south)

Location / Extent: East Anna (see exhibit "A")

Existing Traffic Control: Stop sign on CR 476 with FM 2862

Roadway Width/ Surface Type: CR 476 – 24-feet (2-Lane Asphalt)
CR 475 North of intersection – 22-feet (2-Lane Asphalt)
CR 475 South of intersection – 22-feet (2-Lane Asphalt)

Adjoining Land Development: Pasture/Agricultural

Visibility: Good

Accident History: None have been reported to Public Works Department

Traffic Counts: CR 476 – 13 Cars per Day
CR 475 North of the intersection – 38 Cars per Day
CR 475 South of the intersection – 23 Cars per Day

Application for Stop Sign: A Stop sign is warranted by Section 2B.04, P3, Article A of the 2011 Texas Manual on Uniform Traffic Control Devices.

Other Factors: None

Recommendation: It is recommended that a Stop Sign be placed on CR 476 at the intersection of CR 475, giving the right-of-way to the north-south traffic on CR 475.

Date: October 4, 2016

Engineer: Tracy Homfeld, PE

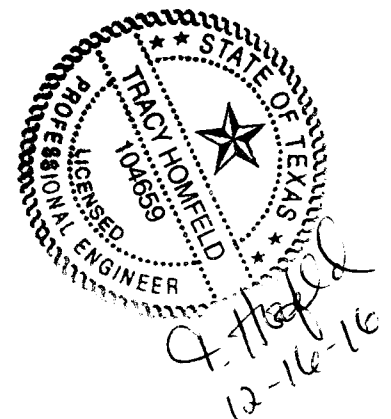

EXHIBIT "A"



COUNTY ROAD 475

COUNTY ROAD 475

SUBJECT LOCATION

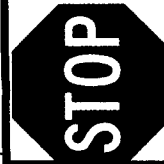

COUNTY ROAD 476

COUNTY ROAD 474

COUNTY ROAD 475



LOCATION MAP CR 476