

Engineering Study
Control Device: Speed Limit Signs CR 570

Roadway / Intersection: County Road 570

Location / Extent: North of Farmersville, from FM 2756 north to County Road 574 (see exhibit "A")

Existing Speed Limit: None

Existing Traffic Control: Stop Sign at the intersection with FM 2194
Stop Sign at the intersection with CR 574

Traffic Counts: 151 Cars per day

Roadway Width/ Surface Type: 24-feet (2-Lane Asphalt)

Adjoining Land Development: Residential/Pasture

Roadway Design Speed: None

Visibility Along the Roadway: Good

Accident History: No speed related accidents reported to Public Works

Radar Speed Survey Result Unable to obtain due to limited traffic at the time of the survey

Other Factors: Many sharp turns along the road

Recommendation: A 40 M.P.H. Speed Limit is recommended along the entire road.

Date: August 3, 2020

Engineer: Mark Hines, P.E.

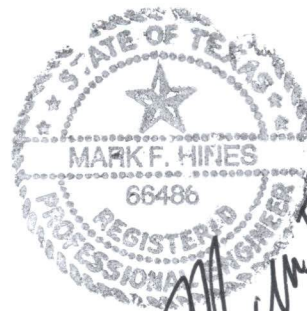

A handwritten signature in black ink, appearing to read "Mark F. Hines", written over the bottom right portion of the professional seal.

EXHIBIT "A"

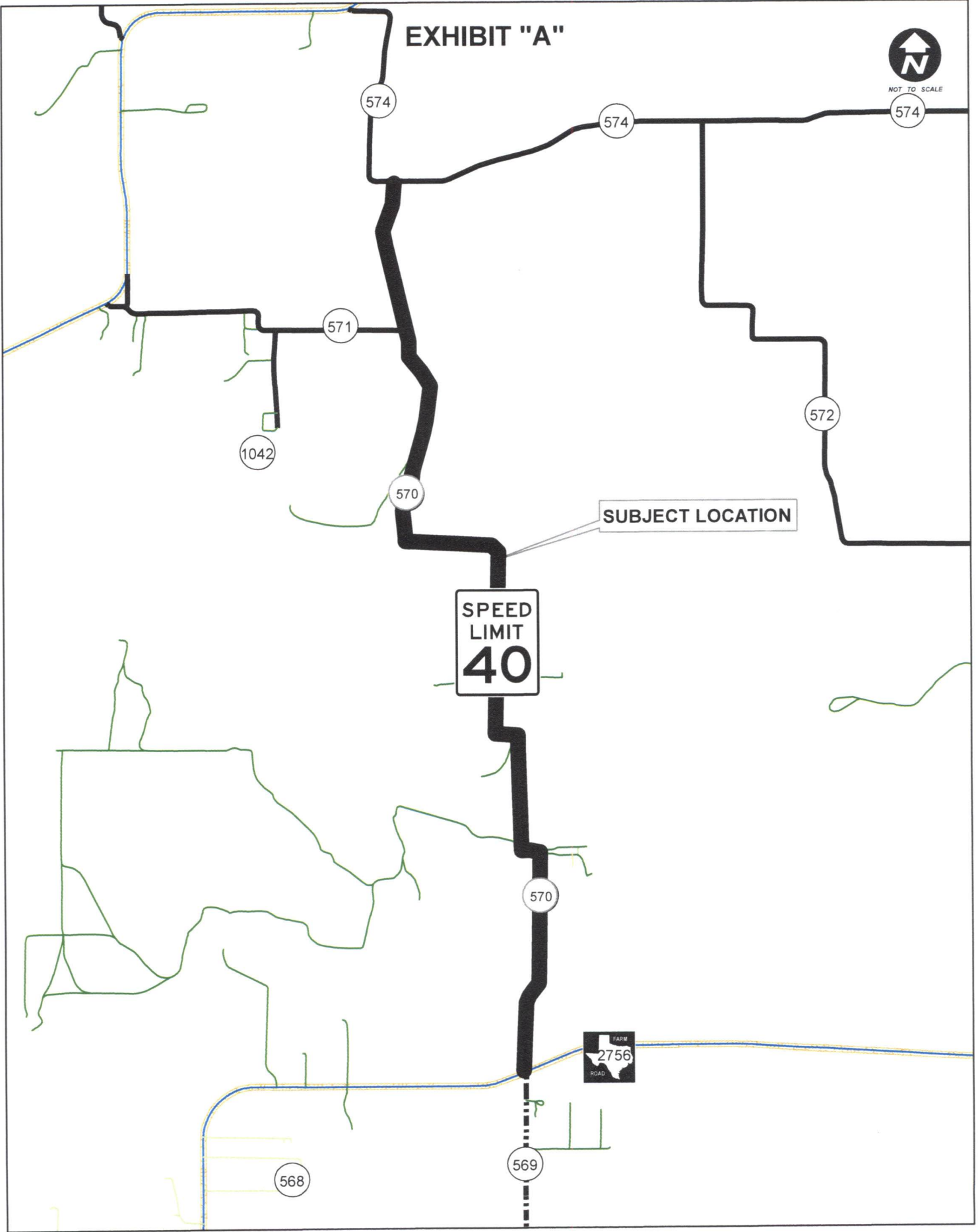

LOCATION MAP CR 570

Engineering Study

Control Device: Stop Sign CR 602

Roadway / Intersection: Intersection of CR 602 (south) with CR 605 (east and west)

Location / Extent: South of Farmersville (see exhibit "A")

Existing Traffic Control: 40 MPH Speed Limit on County Road 602
Stop Sign on County Road 602 at County Road 643

Roadway Width/ Surface Type: CR 602 – 22-feet (2-Lane Asphalt)
CR 605 West of intersection – 23-feet (2-Lane Asphalt)
CR 605 East of intersection – 23-feet (2-Lane Asphalt)

Adjoining Land Development: Pasture/Residential

Visibility: Good

Accident History: None have been reported to Public Works Department

Traffic Counts: CR 602 – 91 Cars per Day
CR 605 West of the intersection – 145 Cars per Day
CR 605 East of the intersection – 194 Cars per Day

Application for Stop Sign: A Stop sign is warranted by Section 2B.04, P2, Article B of the 2011 Texas Manual on Uniform Traffic Control Devices.

Other Factors: None

Recommendation: It is recommended that a Stop Sign be placed on CR 602 at its intersection with CR 605.

Date: August 3, 2020

Engineer: Mark Hines, P.E.



A handwritten signature in black ink, appearing to read "Mark F. Hines", written over the bottom right portion of the professional seal.

EXHIBIT "A"

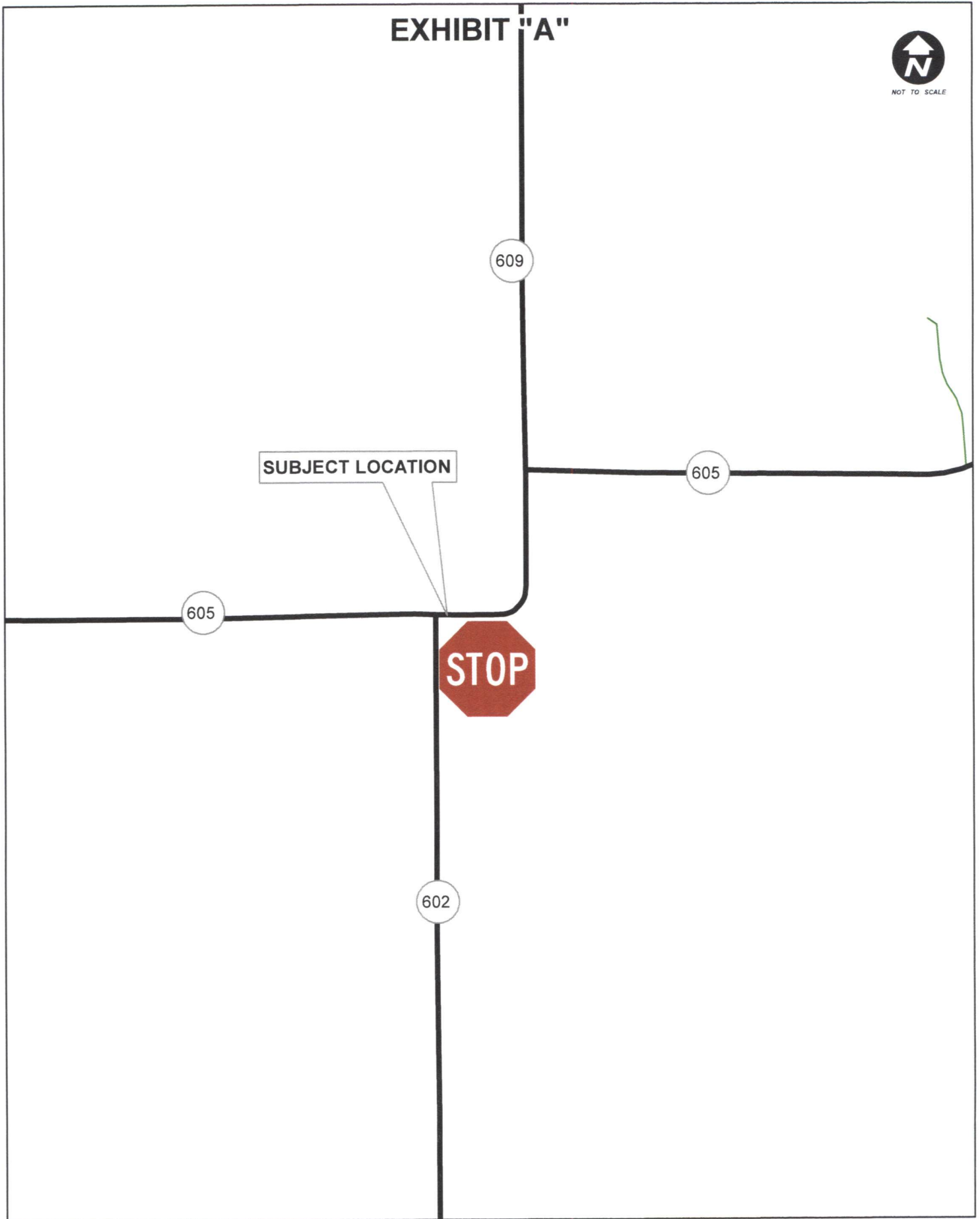

LOCATION MAP CR 602

Engineering Study

Control Device: Stop Sign CR 605

Roadway / Intersection: Intersection of CR 605 (east) with CR 609 (north) and CR 605 (south)

Location / Extent: South of Farmersville (see exhibit "A")

Existing Traffic Control: 40 MPH Speed Limit on County Road 605

Roadway Width/ Surface Type: CR 605 – 23-feet (2-Lane Asphalt)
CR 609 North of intersection – 22-feet (2-Lane Asphalt)
CR 605 South of intersection – 23-feet (2-Lane Asphalt)

Adjoining Land Development: Pasture/Residential

Visibility: Good

Accident History: None have been reported to Public Works Department

Traffic Counts: CR 605 – 178 Cars per Day
CR 609 North of the intersection – 184 Cars per Day
CR 605 South of the intersection – 198 Cars per Day

Application for Stop Sign: A Stop sign is warranted by Section 2B.04, P2, Article B of the 2011 Texas Manual on Uniform Traffic Control Devices.

Other Factors: None

Recommendation: It is recommended that a Stop Sign be placed on CR 605 at its intersection with CR 609 and CR 605.

Date: August 5, 2020

Engineer: Mark Hines, P.E.



A handwritten signature in black ink, appearing to read "Mark F. Hines", written over the bottom right portion of the professional seal.

EXHIBIT "A"



609

SUBJECT LOCATION



605

605

602



LOCATION MAP CR 605

Engineering Study
Control Device: Stop Sign CR 677

Roadway / Intersection: Intersection of CR 677 (west) with CR 678 (north and south)

Location / Extent: Northeast of Royse City (see exhibit "A")

Existing Traffic Control: None

Roadway Width/ Surface Type: CR 677 – 16-feet (2-Lane Asphalt)
CR 678 North of intersection – 22-feet (2-Lane Asphalt)
CR 678 South of intersection – 22-feet (2-Lane Asphalt)

Adjoining Land Development: Pasture/Residential

Visibility: Good

Accident History: None have been reported to Public Works Department

Traffic Counts: CR 677 – 116 Cars per Day
CR 678 North of the intersection – 221 Cars per Day
CR 678 South of the intersection – 231 Cars per Day

Application for Stop Sign: A Stop sign is warranted by Section 2B.04, P2, Article B of the 2011 Texas Manual on Uniform Traffic Control Devices.

Other Factors: None

Recommendation: It is recommended that a Stop Sign be placed on CR 677 at its intersection with CR 678.

Date: August 3, 2020

Engineer: Mark Hines, P.E.



A handwritten signature in black ink, appearing to read "Mark F. Hines", written over the bottom right portion of the professional seal.

EXHIBIT "A"



678

677



SUBJECT LOCATION

COLLIN CO
HUNT CO



LOCATION MAP CR 677

Engineering Study
Control Device: Speed Limit Signs CR 702

Roadway / Intersection: County Road 702

Location / Extent: North of Farmersville, from FM 2194 north to County Road 663 (see exhibit "A")

Existing Speed Limit: None

Existing Traffic Control: Stop Sign at the intersection with FM 2194
Stop Sign at the intersection with CR 663

Traffic Counts: 101 Cars per day

Roadway Width/ Surface Type: 24-feet (2-Lane Asphalt)

Adjoining Land Development: Residential/Pasture

Roadway Design Speed: None

Visibility Along the Roadway: Good

Accident History: No speed related accidents reported to Public Works

Radar Speed Survey Result Unable to obtain due to limited traffic at the time of the survey

Other Factors: None

Recommendation: A 40 M.P.H. Speed Limit is recommended along the entire road.

Date: July 23, 2020

Engineer: Mark Hines, P.E.

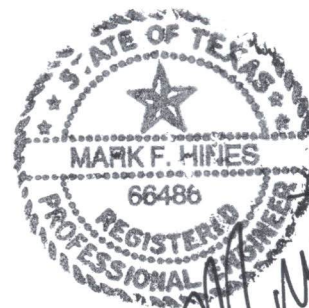

A handwritten signature in black ink, appearing to read "Mark F. Hines", written over the bottom right portion of the professional seal.

EXHIBIT "A"



663

702

SPEED
LIMIT
40

SUBJECT LOCATION



LOCATION MAP CR 702

Engineering Study

Control Device: Stop Signs in Lavon Beach Estates

<u>Roadway / Intersection:</u>	Intersections of CR 1051 with CR 550, CR 1050 with CR 1051, CR 1052 with CR 1051, CR 1064 with CR 550, CR 1064 with CR 1063, CR 1063 with CR 1049, CR 1044 with CR 1049, CR 1048 with CR 1063, CR 1048 with CR 1044, CR 1047 with CR 1063, CR 1047 with CR 1044, CR 1046 with CR 1047, CR 1046 with CR 1044, CR 1045 with CR 1044, CR 1045 with CR 1047, CR 1053 with CR 1049, CR 1047 with CR 1053, CR 1054 with CR 1053, CR 1057 with CR 1054, CR 1057 with CR 1047, CR 1056 with CR 1054, CR 1055 with CR 1054, CR 1055 with CR 1047, CR 1056 with CR 1049, CR 1058 with CR 1049, and CR 1049 with CR 1059.
<u>Location / Extent:</u>	South of Farmersville in Lavon Beach Estates (see exhibit "A")
<u>Existing Traffic Control:</u>	Speed Limit 30 MPH
<u>Roadway Width/ Surface Type:</u>	All roads 16-feet (2-Course)
<u>Adjoining Land Development:</u>	Residential
<u>Visibility:</u>	Good
<u>Accident History:</u>	Accident at the intersection of CR 1047 and CR 1053
<u>Traffic Counts:</u>	None taken for this study as these roads lie within a residential subdivision.
<u>Warrant for Stop Sign:</u>	Stop signs are warranted by Section 2B.04, P3, Article A of the 2011 Texas Manual on Uniform Traffic Control Devices.
<u>Other Factors:</u>	None
<u>Recommendation:</u>	It is recommended that Stop Signs be placed on CR 1051 with CR 550, CR 1050 with CR 1051, CR 1052 with CR 1051, CR 1064 with CR 550, CR 1064 with CR 1063, CR 1063 with CR 1049, CR 1044 with CR 1049, CR 1048 with CR 1063, CR 1048 with CR 1044, CR 1047 with CR 1063, CR 1047 with CR 1044, CR 1046 with CR 1047, CR 1046 with CR 1044, CR 1045 with CR 1044, CR 1045

with CR 1047, CR 1053 with CR 1049, CR 1047 with CR 1053, CR 1054 with CR 1053, CR 1057 with CR 1054, CR 1057 with CR 1047, CR 1056 with CR 1054, CR 1055 with CR 1054, CR 1055 with CR 1047, CR 1056 with CR 1049, CR 1058 with CR 1049, and CR 1049 with CR 1059 as shown on the attached "Exhibit A".

Date:

September 11, 2020

Engineer:

Mark Hines, P.E.

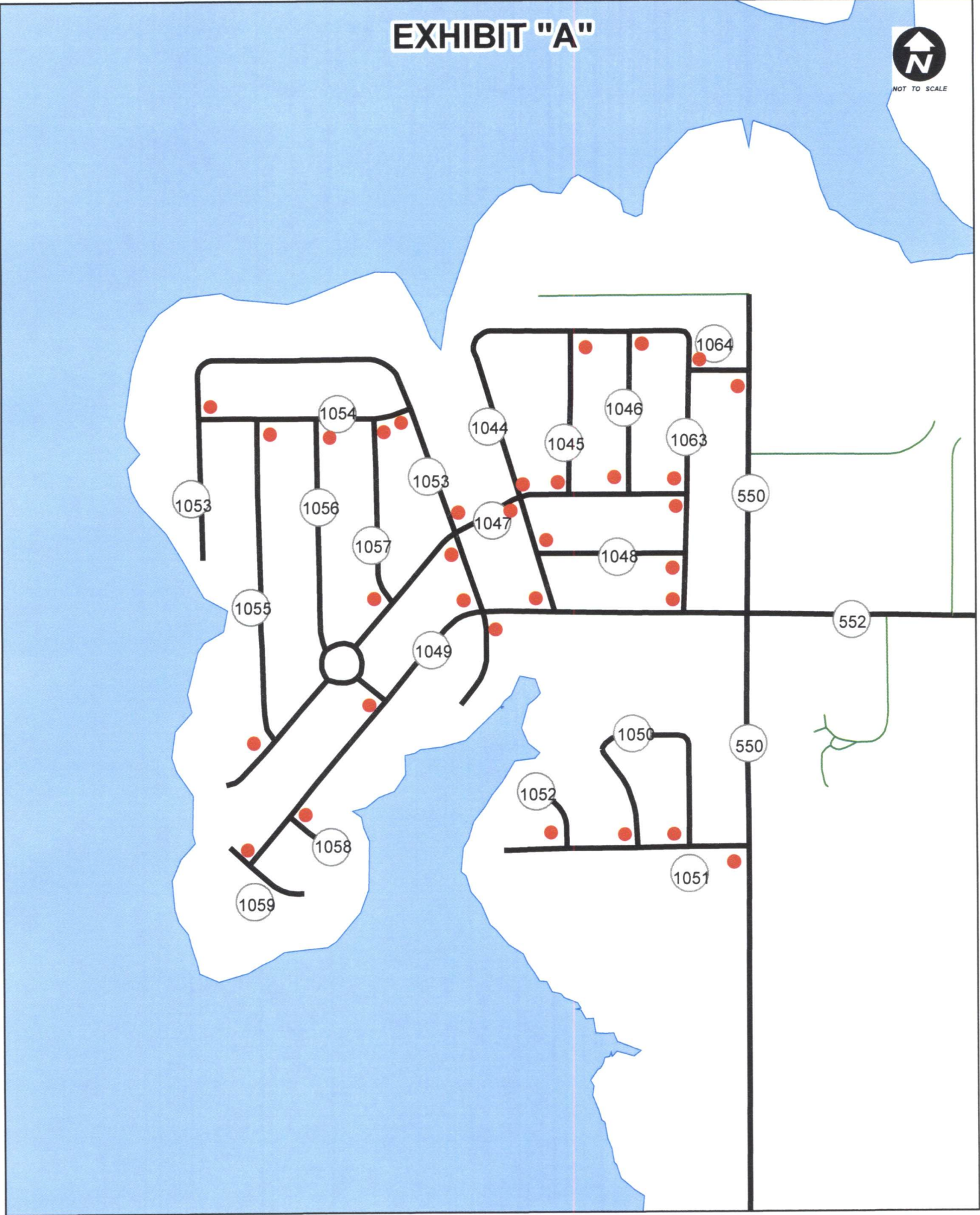

EXHIBIT "A"



LOCATION MAP LAVON BEACH ESTATES

Engineering Study
Control Device: Yield Signs in Lavon Beach Estates

Roadway / Intersection: Intersections of CR 1047 with CR 1056 and CR 1056 with CR 1047.

Location / Extent: South of Farmersville in Lavon Beach Estates (see exhibit "A")

Existing Traffic Control: Speed Limit 30 MPH

Roadway Width/ Surface Type: All roads 16-feet (2-Course)

Adjoining Land Development: Residential

Visibility: Good

Accident History: None reported

Traffic Counts: None taken for this study as these roads lie within a residential subdivision.

Warrant for Stop Sign: Yield Signs are warranted by Section 2B.04, P4, Article B of the 2011 Texas Manual on Uniform Traffic Control Devices.

Other Factors: None

Recommendation: It is recommended that Yield Signs be placed on CR 1047 with CR 1056 and CR 1056 with CR 1047 as shown on the attached "Exhibit A".

Date: September 11, 2020

Engineer: Mark Hines, P.E.

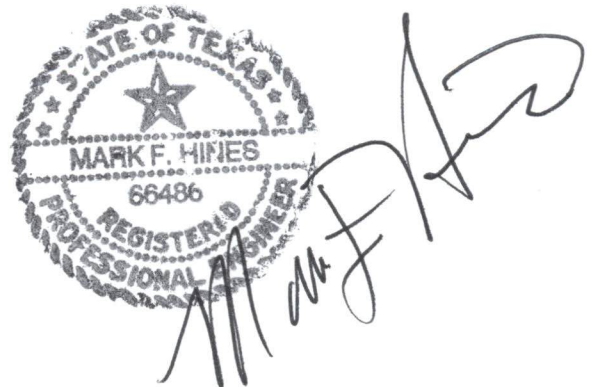
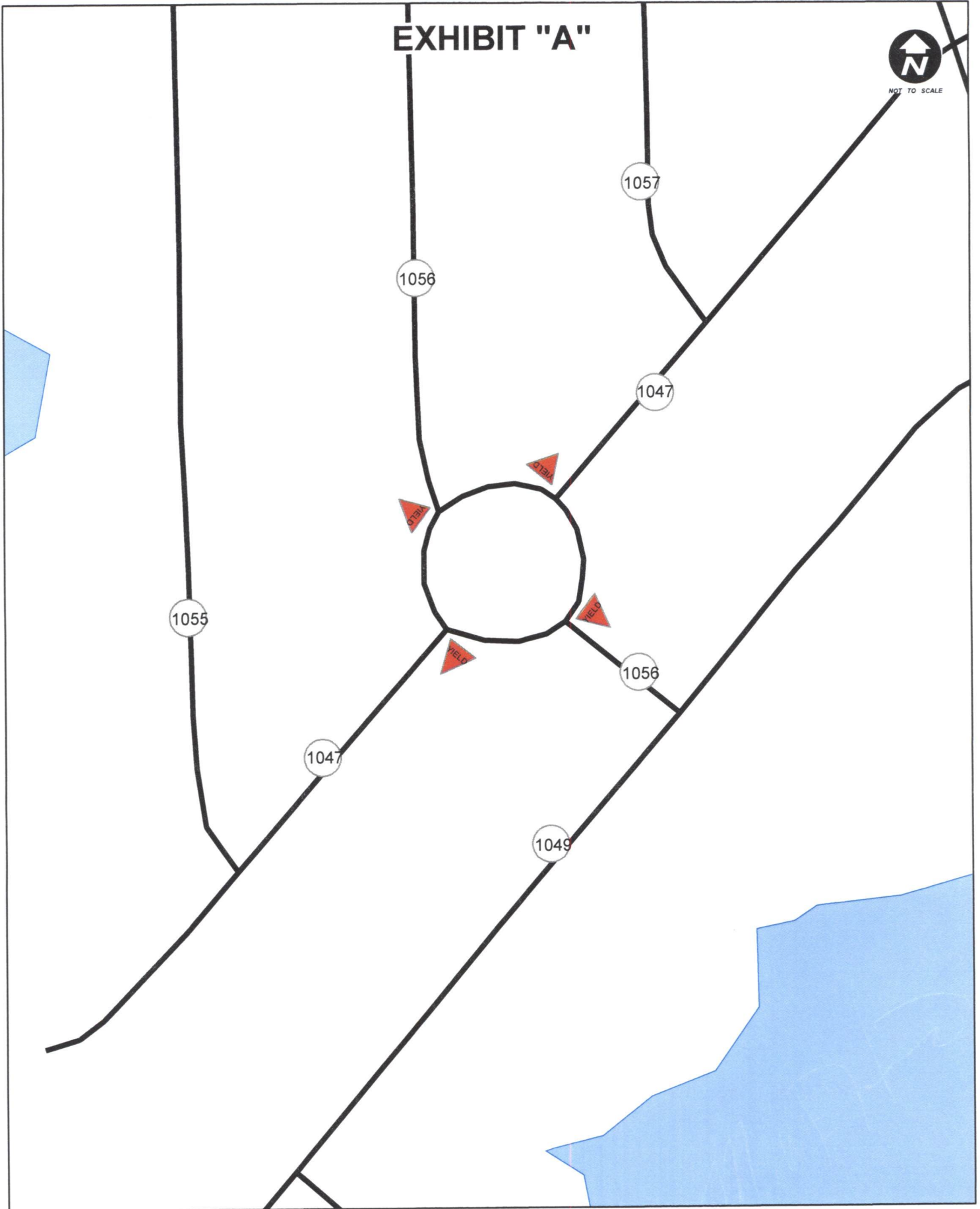

EXHIBIT "A"



NOT TO SCALE



LOCATION MAP LAVON BEACH ESTATES