

Plotted By: Connell, Sarah Date: November 13, 2020 04:35:26pm File Path: K:\Projects\06815000 - Trinity Falls\Drawings\CR 206\plansheets\C-Traffic Control-Detour-N\_Phase One.dwg  
 This document, together with the concepts and designs presented herein, is intended only for the specific purpose and client for which it was prepared. Reuse of and improper reliance on this document without written authorization and adaptation by Kimley-Horn and Associates, Inc. shall be without liability to Kimley-Horn and Associates, Inc.

**RELEASED FOR CONSTRUCTION**  
 CITY OF MCKINNEY ENGINEERING DEPARTMENT  
 December 22, 2020 by T. Schauwecker

Prior to commencing construction, the owner or their representative shall hold a Pre-Construction Conference with and be issued a Development Permit by the City of McKinney Engineering Department. A copy of the Development Permit and these stamped construction drawings shall be maintained on the construction site at all times. If a conflict is found between these construction drawings and the City of McKinney Construction Standards, the City of McKinney Construction Standards shall govern.

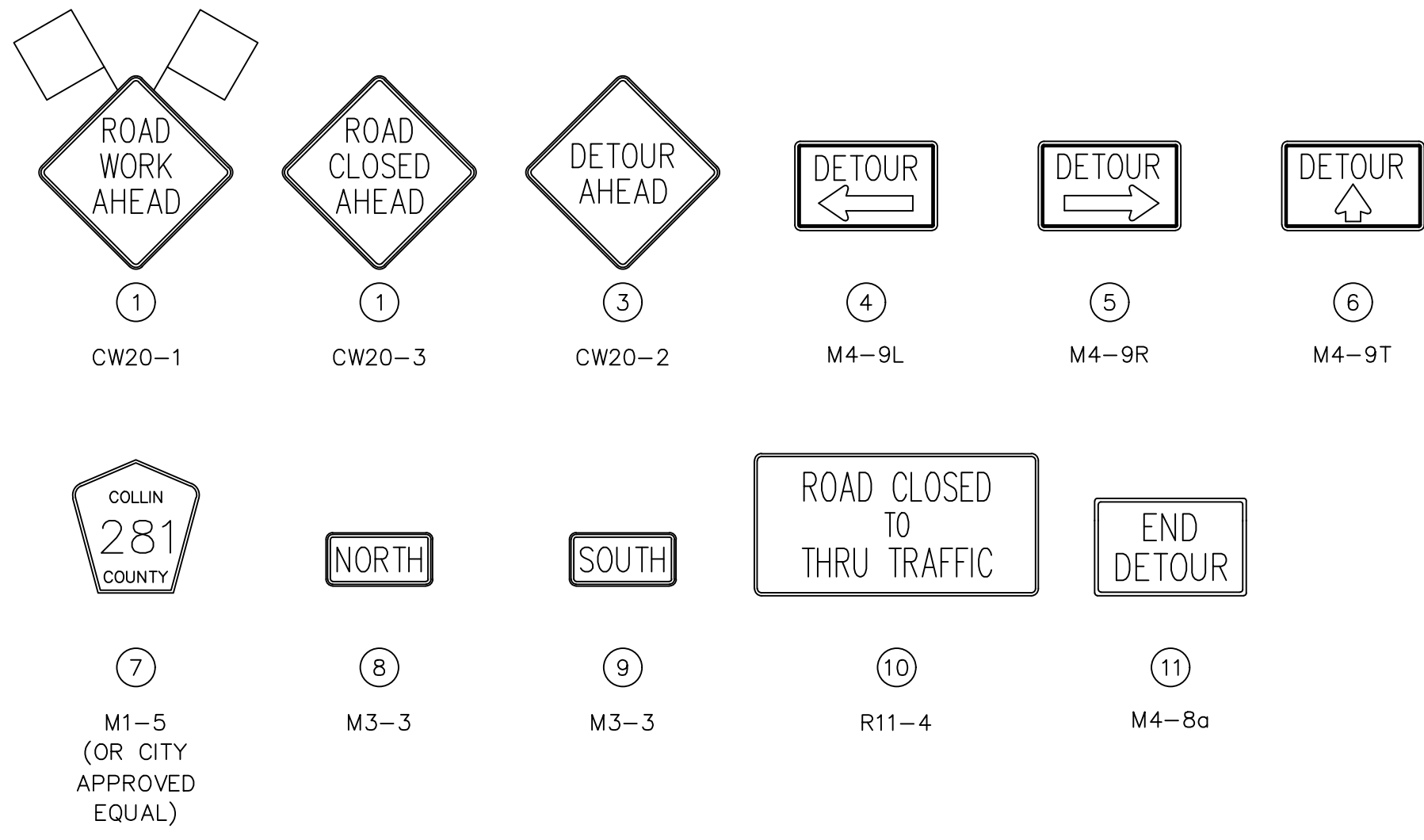
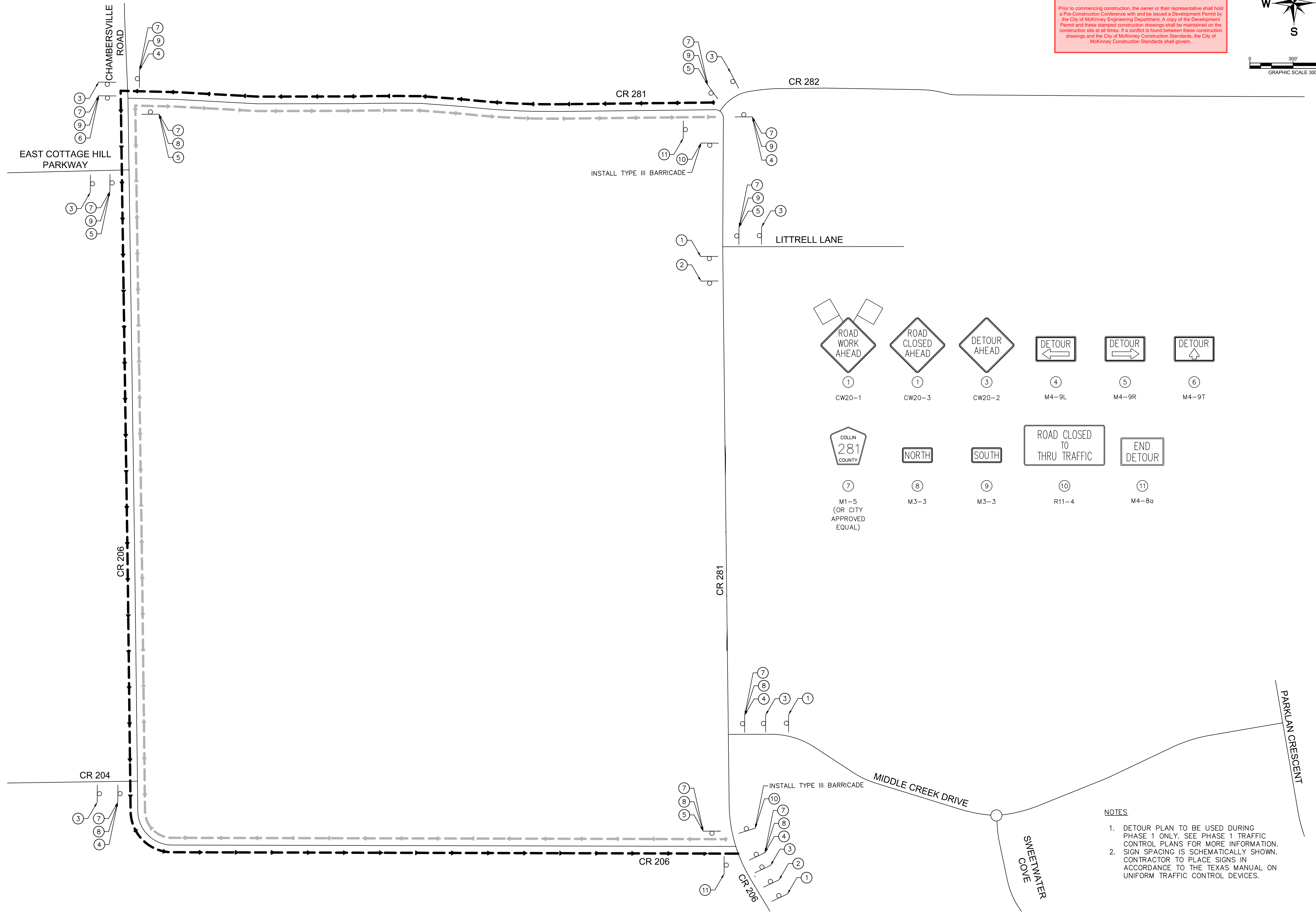
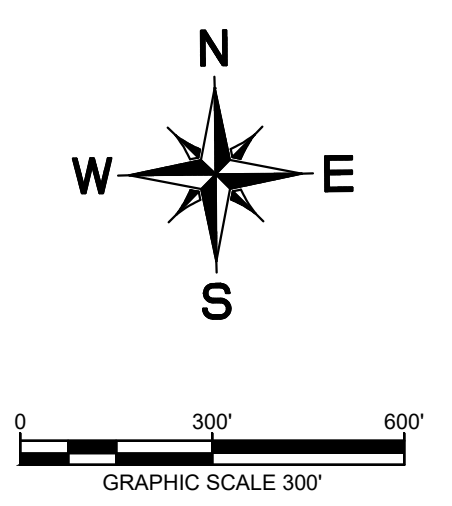

- NOTES**
1. DETOUR PLAN TO BE USED DURING PHASE 1 ONLY. SEE PHASE 1 TRAFFIC CONTROL PLANS FOR MORE INFORMATION.
  2. SIGN SPACING IS SCHEMATICALLY SHOWN. CONTRACTOR TO PLACE SIGNS IN ACCORDANCE TO THE TEXAS MANUAL ON UNIFORM TRAFFIC CONTROL DEVICES.

No.	REVISIONS	DATE	BY

**Kimley & Horn**

© 2020 KIMLEY-HORN AND ASSOCIATES, INC.  
 5750 GENESIS COURT, SUITE 200, FRISCO, TX 75034  
 PHONE: 972-335-3580 FAX: 972-335-3779  
 WWW.KIMLEY-HORN.COM

TEXAS REGISTERED ENGINEERING FIRM F-928



KHA PROJECT	068150035
DATE	NOVEMBER 2020
SCALE	AS SHOWN
DESIGNED BY	DRB
DRAWN BY	RTD
CHECKED BY	RLK

**DETOUR PLAN**

**TRINITY FALLS PARKWAY  
 (CR 206/CR 281)**  
 CITY OF MCKINNEY  
 COLLIN COUNTY, TEXAS

Plotted By: Connell, Sarah Date: November 13, 2020 04:35:45pm File Path: K:\Vr\civil\06815003 - trinity falls\06815003 - Traffic Control\Detour\Phase Two.dwg  
 This document, together with the concepts and designs presented herein, is intended only for the specific purpose and client for which it was prepared. Reuse of and improper reliance on this document without written authorization and adaptation by Kimley-Horn and Associates, Inc. shall be without liability to Kimley-Horn and Associates, Inc.

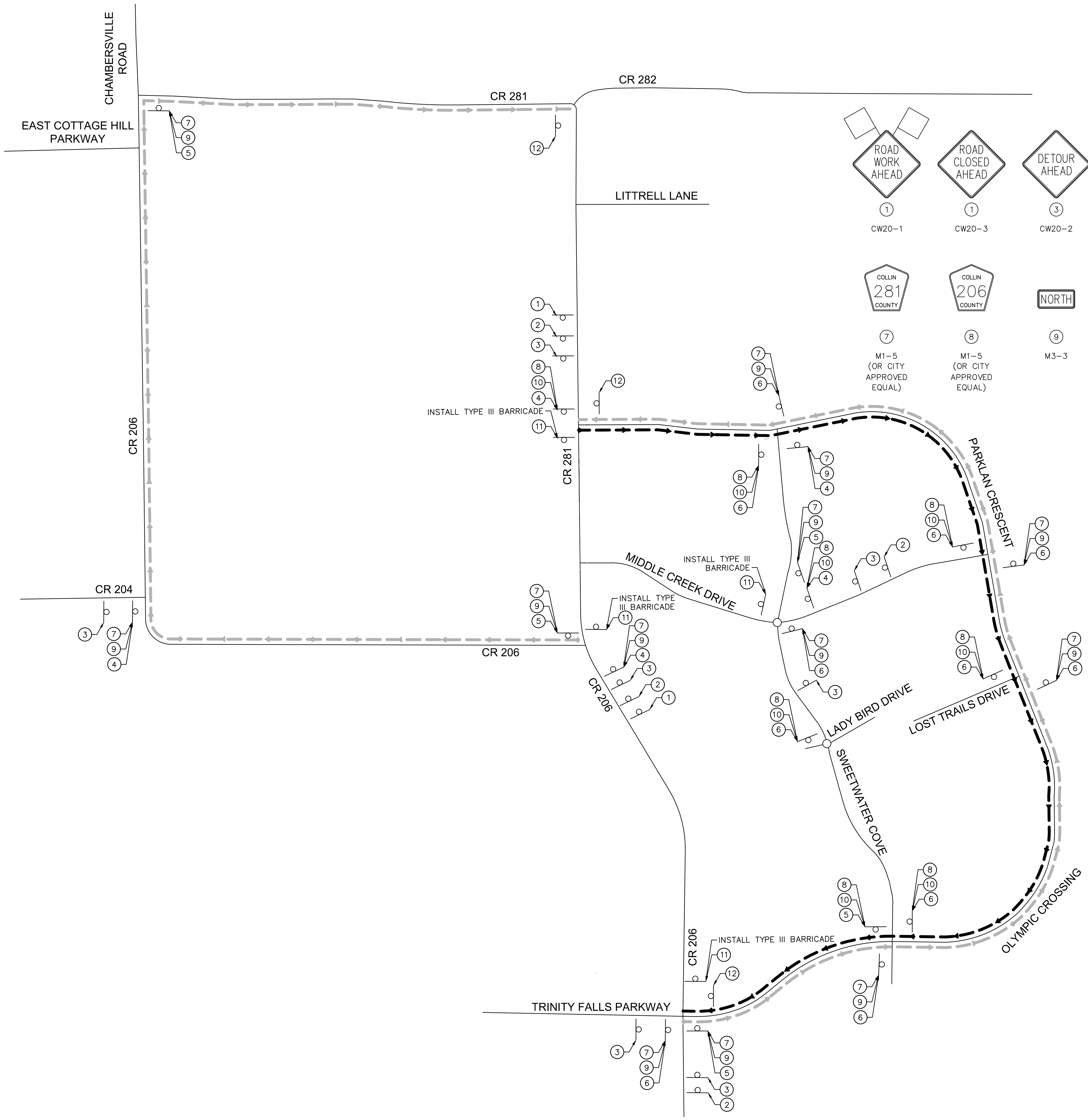

**RELEASED FOR CONSTRUCTION**  
 CITY OF MCKINNEY ENGINEERING DEPARTMENT  
 December 22, 2020 by T. Schauwecker

Prior to commencing construction, the owner or their representative shall hold a Pre-Construction Conference with and be issued a Development Permit by the City of McKinney Engineering Department. A copy of the Development Permit and these stamped construction drawings shall be maintained on the construction site at all times. If a conflict is found between these construction drawings and the City of McKinney Construction Standards, the City of McKinney Construction Standards shall govern.

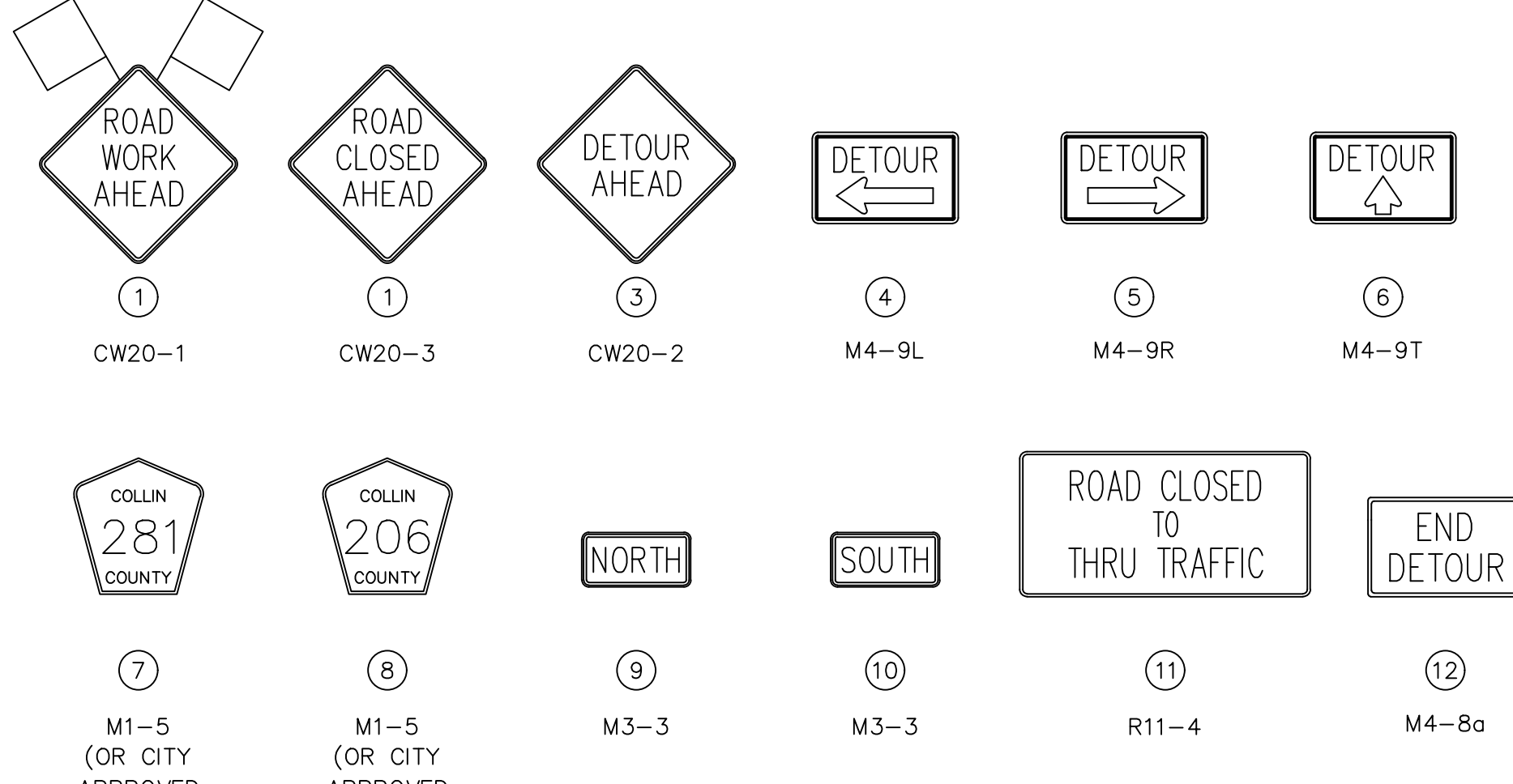
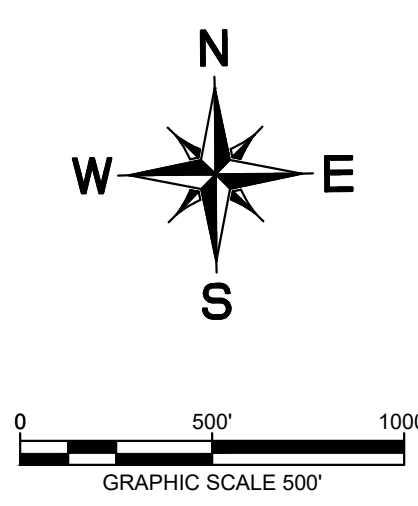

- NOTES**
1. DETOUR PLAN TO BE USED DURING PHASE 2 ONLY. SEE PHASE 2 TRAFFIC CONTROL PLANS FOR MORE INFORMATION.
  2. SIGN SPACING IS SCHEMATICALLY SHOWN. CONTRACTOR TO PLACE SIGNS IN ACCORDANCE TO THE TEXAS MANUAL ON UNIFORM TRAFFIC CONTROL DEVICES.

No.	REVISIONS	DATE	BY

**Kimley-Horn**

© 2020 KIMLEY-HORN AND ASSOCIATES, INC.  
 5750 GENESIS COURT, SUITE 200, FRISCO, TX 75034  
 PHONE: 972-335-3580 FAX: 972-335-3779  
 WWW.KIMLEY-HORN.COM

TEXAS REGISTERED ENGINEERING FIRM F-928

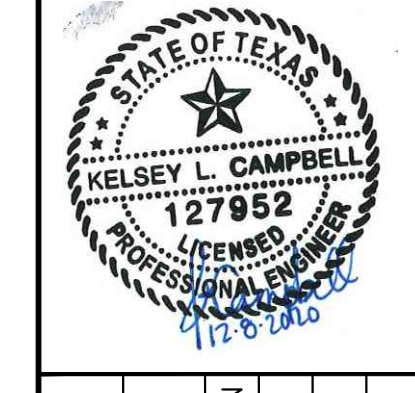

KHA PROJECT	068150035
DATE	NOVEMBER 2020
SCALE	AS SHOWN
DESIGNED BY	DRB
DRAWN BY	RTD
CHECKED BY	RLK

**DETOUR PLAN**

**TRINITY FALLS PARKWAY  
 (CR 206/CR 281)**  
 CITY OF MCKINNEY  
 COLLIN COUNTY, TEXAS