

LIMIT OF DETAILED STUDY  
 FIRM NO. 48085C0280J & 48085C0290J  
 (JUNE 2, 2009)

	RIVER/TRIBUTARY	STREAM MILES
OPTION 1	EAST FORK TRINITY RIVER	8.5
	OPTION 1 TOTAL:	8.5
OPTION 2	EAST FORK TRINITY RIVER	8.5
	TRIBUTARIES TO EAST FORK TRINITY RIVER	10
	OPTION 2 TOTAL:	18.5

OPTION NO. 1  
 EAST FORK TRINITY RIVER

OPTION NO. 2  
 EAST FORK TRINITY RIVER  
 +  
 TRIBUTARIES TO EAST FORK TRINITY RIVER

This portion was added.  
 Approximately 0.5 miles

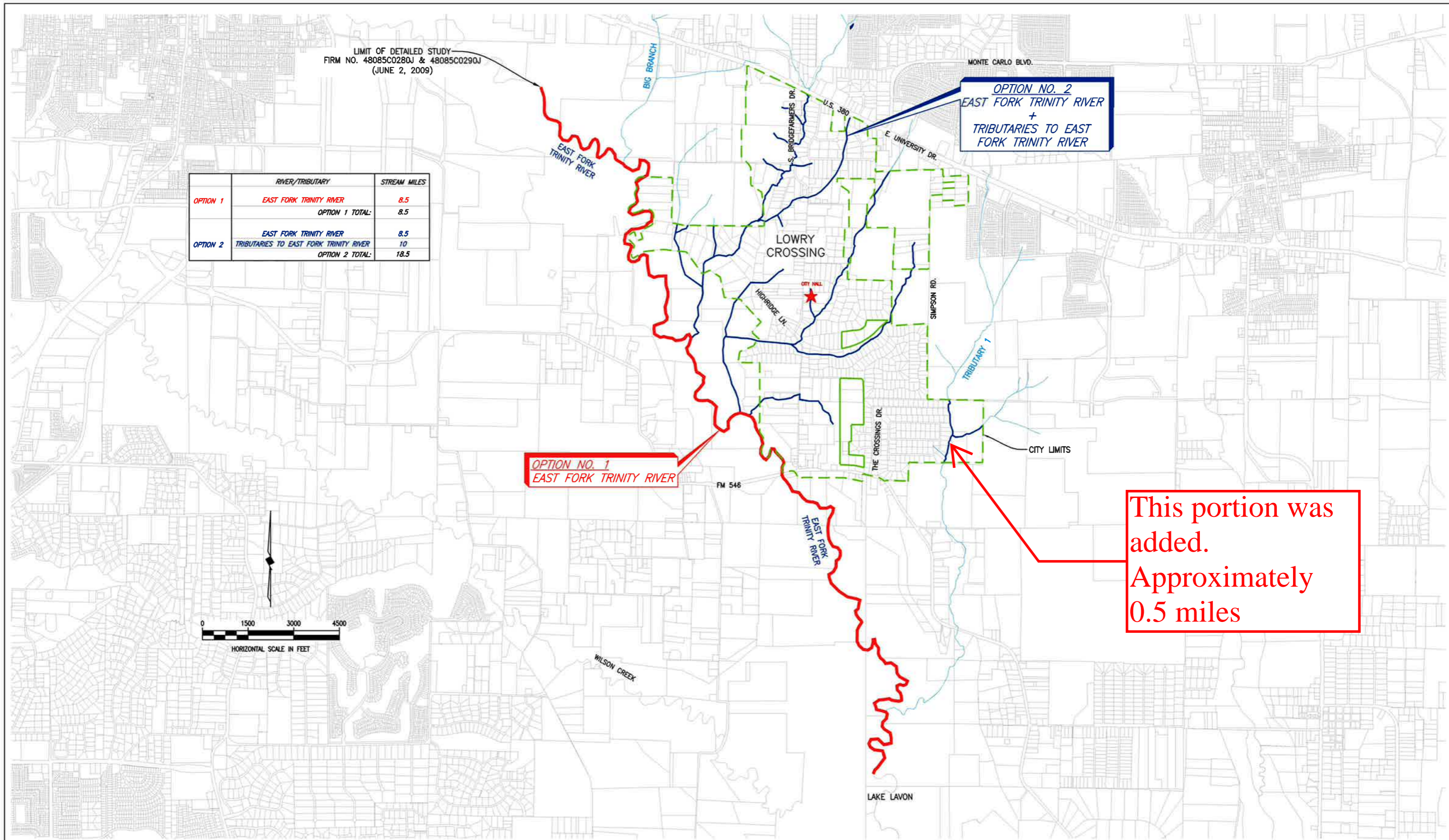
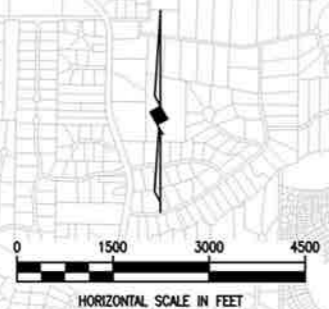

These plans and related specifications were prepared for construction of this specific project only. Reuse of these documents is not permitted without written authorization of Birkhoff, Hendricks & Carter, L.L.P. If this drawing is converted to an electronic file, if any discrepancy occurs between the electronic file and the Birkhoff, Hendricks & Carter, L.L.P. original document, the original document will govern in all cases.

**BIRKHOFF, HENDRICKS & CARTER, L.L.P.**  
 PROFESSIONAL ENGINEERS  
 TBPE Firm No. 526; TBPLS Firm No. 10031800  
 11910 Greenville Ave., Suite 600  
 Dallas, Texas 75243 (214) 361-7900

THESE DOCUMENTS ARE FOR INTERIM REVIEW AND ARE NOT INTENDED FOR CONSTRUCTION, BIDDING, OR PERMIT PURPOSES.  
 CRAIG M. KERKHOFF  
 TEXAS P.E. NO. 106102  
 DATE: November 2020

**CITY OF LOWRY CROSSING, TEXAS**  
 PRINCETON DRAINAGE EXHIBIT  
 DRAINAGE EXHIBIT

BHC  
 PROJECT NO.  
 BUSDEV  
 NOVEMBER, 2020

SHEET NO.  
**EX**