

RESOLUTION NO. 2021-27(R)

A RESOLUTION OF THE CITY COUNCIL OF THE CITY OF WYLIE, TEXAS, RECOGNIZING AND OFFERING NO OBJECTION TO THE INTENT OF ROERS WYLIE APARTMENTS OWNER LIMITED PARTNERSHIP TO SUBMIT AN APPLICATION TO THE TEXAS DEPARTMENT OF HOUSING AND COMMUNITY AFFAIRS FOR 2021 HOUSING TAX CREDITS TO DEVELOP WYLIE SENIOR APARTMENTS; PROVIDING FOR AN EFFECTIVE DATE.

WHEREAS, Roers Wylie Apartments Owner Limited Partnership has proposed a development for affordable rental housing of approximately 215 units that will be located at or about the south side of FM 544 approximately 1400' west of Sanden Boulevard; and

WHEREAS, Roers Wylie Apartments Owner Limited Partnership has or will submit an application to the Texas Department of Housing and Community Affairs for 2021 Housing Tax Credits for Wylie Senior Apartments.

NOW, THEREFORE, THAT IN ACCORDANCE WITH THE REQUIREMENTS OF TEX. GOV'T CODE §2306.67071 AND 10 TAC §11.204(4), BE IT RESOLVED BY THE CITY COUNCIL OF THE CITY OF WYLIE, TEXAS:

SECTION 1: Notice has been provided to the City Council in accordance with Tex. Gov't Code, §2306.67071(a); and

SECTION 2: The City Council has had sufficient opportunity to obtain a response from the Applicant regarding any questions or concerns about the proposed Development; and:

SECTION 3: The City Council has held a hearing at which public comment may be made on the proposed Development in accordance with Tex. Gov't Code, §2306.67071(b); and

SECTION 4: After due consideration of the information provided by the Applicant as demonstrated in Exhibit A and public comment, the City Council does not object to the proposed Application; and

SECTION 5: This Resolution shall take effect immediately from and after its passage.

DULY PASSED AND APPROVED BY THE CITY COUNCIL OF THE CITY OF WYLIE, TEXAS on this 14th day of September, 2021.

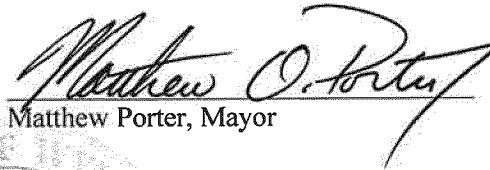
Matthew Porter, Mayor

ATTESTED AND CORRECTLY RECORDED:

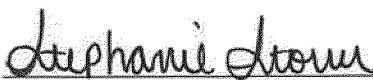
Stephanie Storm, City Secretary

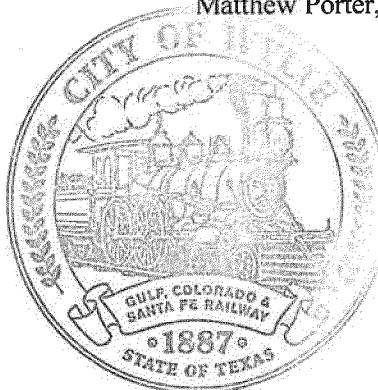
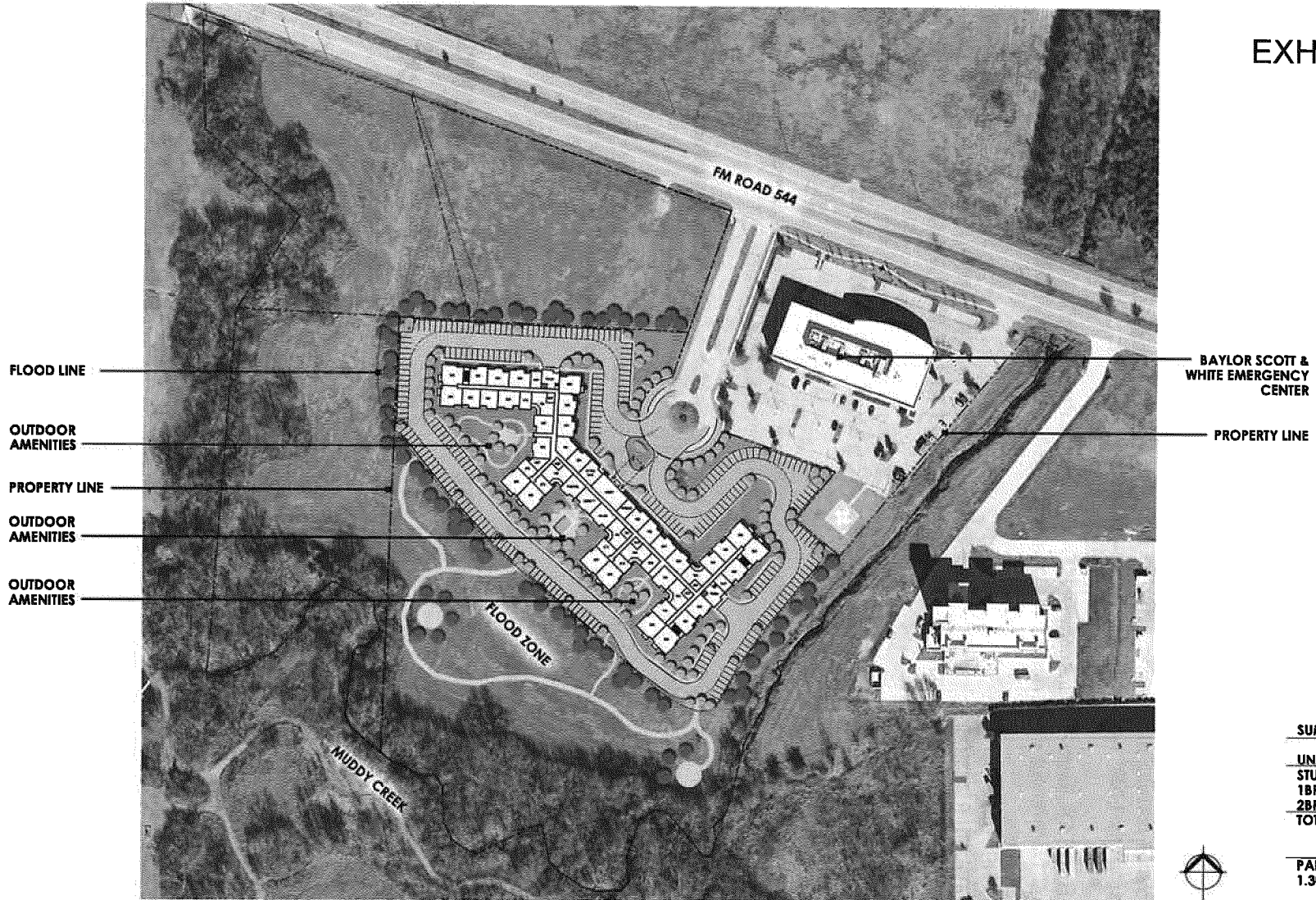

EXHIBIT A



SUMMARY

UNITS:	
STUDIOS	31
1BR	94
2BR	80
TOTAL	205

PARKING PROVIDED
1.30 X 205 = 267



Senior Living Site Test Fit - 205 Unit Option
2310 W FM 544 - WYLIE, TX
 08.18.2021



TRASH PICK UP

FLOOD LINE

OUTDOOR FIRE PIT

PROPERTY LINE

OUTDOOR POOL AREA

YOGA/TAI CHI PARK

REST STATION

REST STATION

BAYLOR SCOTT & WHITE
EMERGENCY CENTER

TRASH PICK UP

PROPERTY LINE

SUMMARY

UNITS:

STUDIOS	31
1BR	94
2BR	80
TOTAL	205

PARKING PROVIDED
1.30 X 205 = 267

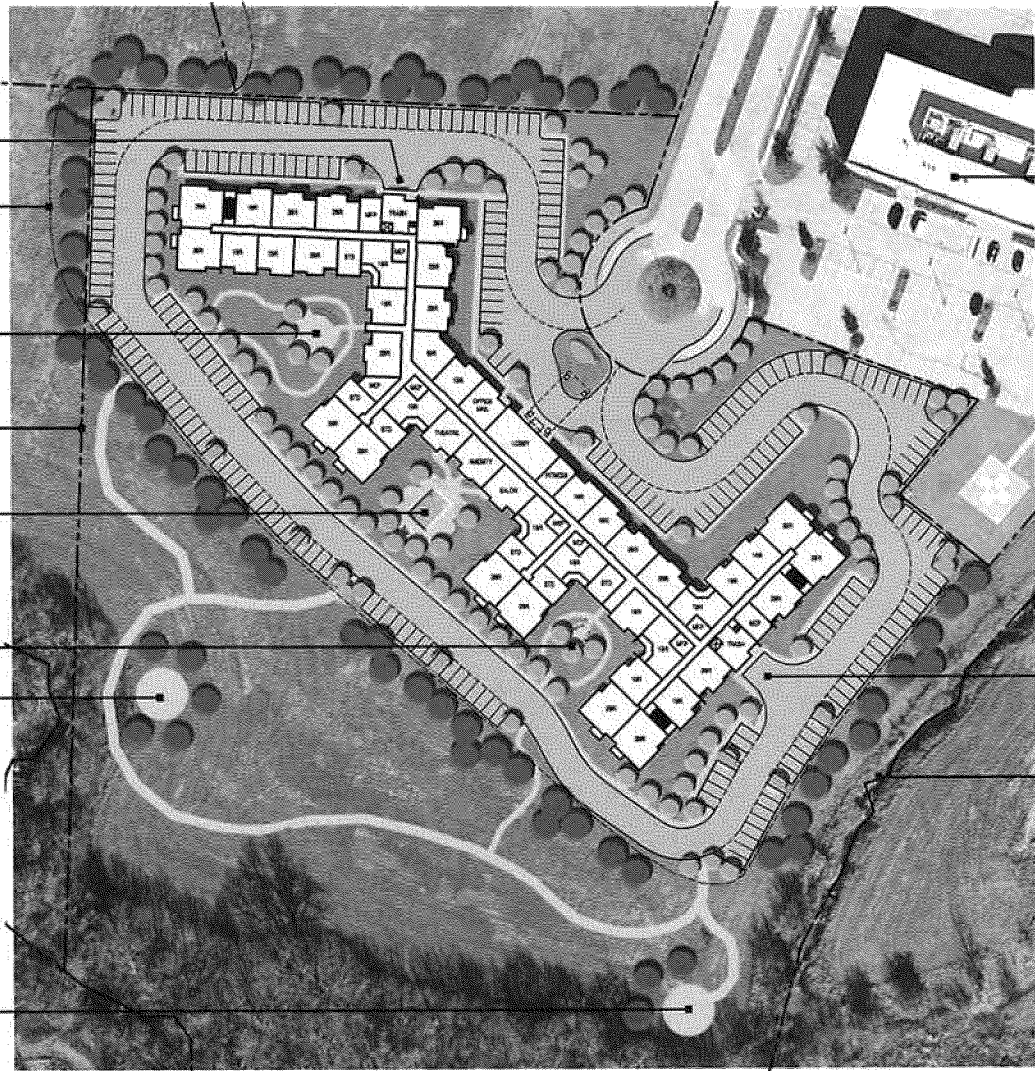

Senior Living Site Test Fit - 205 Unit Option
2310 W FM 544 - WYLIE, TX

08.18.2021

