



# The Need for More District Courts: Part Two

---

JUDGE TOM NOWAK ON  
BEHALF OF THE COLLIN  
COUNTY DISTRICT COURTS

# Bottom Line Up Front

---

The Collin County District Judges request a vote, by the Honorable Commissioners' Court of Collin County, in favor of the 88<sup>th</sup> Legislature adding two (2) new general jurisdiction district courts in and for Collin County.

We believe this request is necessary

- To meet the growing needs of our ever increasing population
- To continue to provide the excellent service Collin County citizens expect
- To ensure that justice is swift and fair
- To keep Collin County as the model of efficiency it has become.

# Collin County Population Growth

---

	Population	Increase
2010	782,341	
2020	1,064,465	+282,124 (#8 in ALL OF U.S.)
2021	1,109,462	+36,313 (#2 in ALL OF U.S.)
2025	Over 1,250,000	+35,135 (per year)??

Collin County will add the population equivalent of a city, the size of McKinney, by the time the next opportunity to add courts comes around.

Our Citizens  
Our Jurors  
Our Litigants

“Collin County, for example, employers would say, is among the best places they could possibly go in the United States to find a big, deep, well-trained, well-educated pool of potential workers that they can select from, that they can compete for.”

Source: DMN (Jul 18, 2022)

# Comparison To Similar Sized Counties

---

		TOTAL	Population	Pop vs. Collin	Pop per Ct	Disposition Rate '21	'20 vs. '21 Backlog
1	Harris	61	4731145	444%	77,560	90.51%	15,287
2	Dallas	39	2613539	246%	67,014	99.60%	345
3	Tarrant	28	2110640	198%	75,380	101.69%	(1,064)
4	Bexar	27	2009324	194%	74,419	86.19%	4,041
5	Travis	21	1290188	121%	61,438	91.58%	2,249
6	Collin	13	1064465	100%	81,881	102.93%	(732)
7	Denton	11	906422	85%	82,402	98.64%	232
8	Hidalgo	12	870781	82%	72,565	85.03%	2,655
9	El Paso	15	865657	81%	57,710	118.10%	(1,697)
10	Fort Bend	8	822779	77%	102,874	112.65%	(1,765)

1,250,000 Population = **96,154** Per Court!

CY '21 = 25,000+ Case Filings

CY '25 = 30,250+ Projected Case Filings

2,326 Filings Per Court by 2025

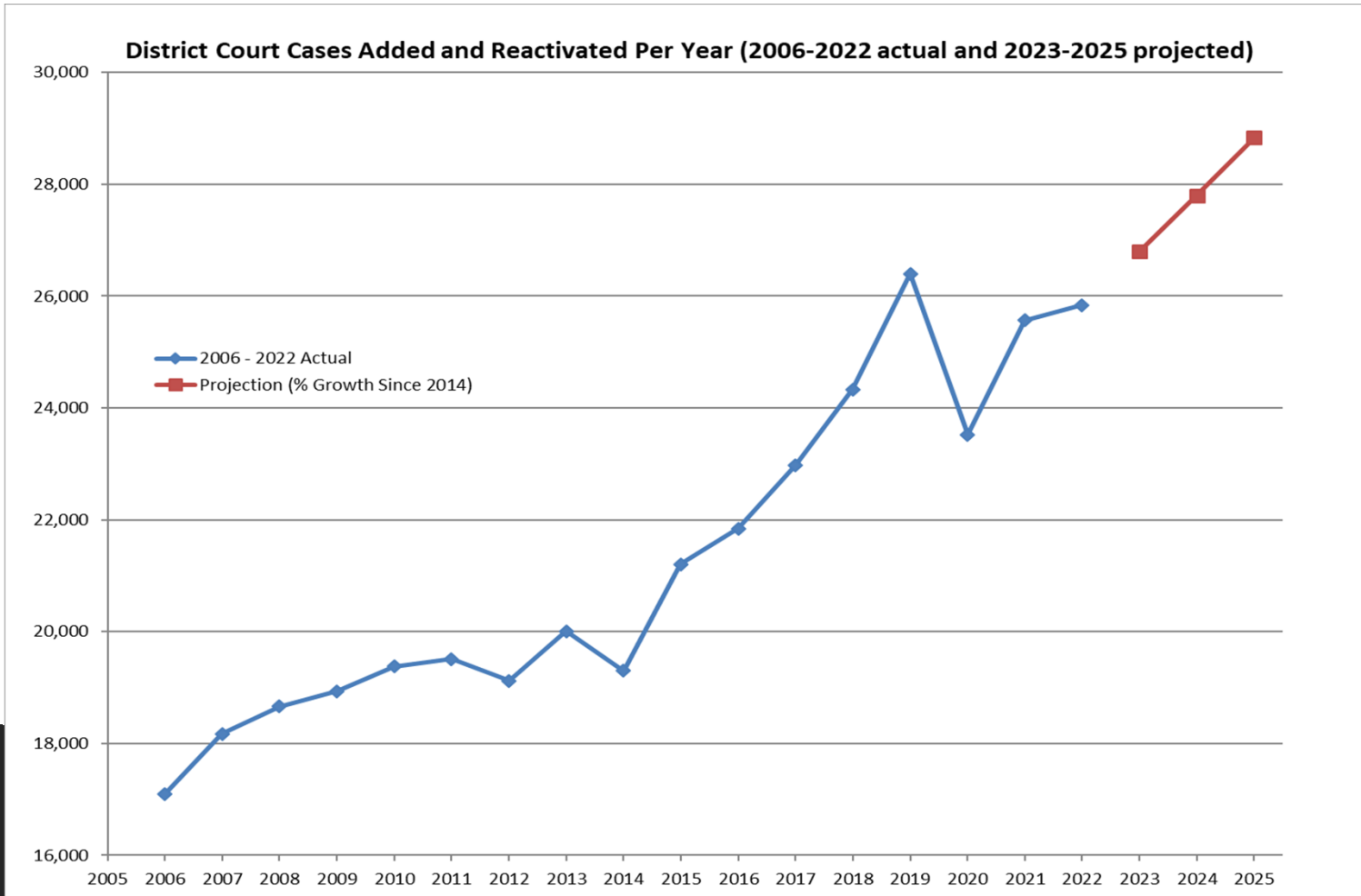

Office of Court Administration Projections – Managed by the Supreme Court of Texas

## District Court Workload Analysis Collin County

This jurisdiction is currently served by 13 district courts. It is also supported by an Office of Court Administration's Child Support Court (0.4 FTE).

County	Estimated FTEs Needed <sup>1</sup>	% Current FTEs State Funded <sup>2</sup>	Filings 2022	Change in Filings 2021-2022	Change in Filings 2018-2022	Clearance Rate 2022	Clearance Rate 2018-2022	Date Last Court Created
Collin	16.8	100%	24,613	-2%	2%	105%	99%	2019 (2 courts)
<b>Total Estimated FTEs Needed</b>	<b>16.8</b>		<b>Statewide Totals, Change in Filings &amp; Clearance Rates</b>	<b>-1%</b>	<b>-13%</b>	<b>99%</b>	<b>92%</b>	
<b>Actual Reported FTEs<sup>2</sup></b>	<b>13.4</b>							

1. Based on the application of case weights to FY 2022 filings as reported to the Office of Court Administration. Details regarding case weights [can be found in the following reports, which are available at http://www.txcourts.gov/publications-training/publications/studies-special-reports/](http://www.txcourts.gov/publications-training/publications/studies-special-reports/): "Measuring Current Judicial Workload in Texas, 2007," National Center for State Courts; and "Texas Child Protective Services Workload Assessment, 2016," National Center for State Courts.
2. District judges as of 10/1/2022. Child protection and child support associate judges based on child protection or child support case filings during fiscal year 2022. Other personnel based on survey responses from county auditors/treasurers as of December 2019.

Prepared 11/14/2022



## District Court Workload Analysis Collin County

### Estimated Need

	Criminal	Civil	Family (incl. Child Support)	CPS	Juvenile	Total
Collin	5.8	4.3	5.8	0.4	0.5	16.8

### Existing Associate Judge/Magistrate Resources

	Criminal	Civil	Family	Child Support	CPS	Juvenile	Total
Collin				0.4			0.4

### Net Need

	Criminal	Civil	Family (incl. Child Support)	CPS	Juvenile	Total	Existing District Judges	Remaining Need
Collin	5.8	4.3	5.4	0.4	0.5	16.4	<b>13.0</b>	<b>3.4</b>

Prepared 11/14/2022





# Regression Analysis

Completed by a student at UTD who works diligently for Collin County.

By Court Types (Resulted in direct correlation to Population)  
By Total Volume of Cases

2,023	13	15
2,024	14	15
2,025	14	16
2,026	15	16
2,027	15	17
2,028	15	18
2,029	16	18
2,030	16	19
2,031	17	20
2,032	17	20
2,033	18	21
2,034	19	22
2,035	19	23
2,036	20	24
2,037	20	25
2,038	21	26
2,039	22	27
2,040	22	28

Year	Courts	Low	Mid	High	Pop
2023	15	13	15	17	1,141,293
2024	15	13	15	17	1,168,395
2025	16	14	16	18	1,195,992
2026	16	14	16	18	1,224,169
2027	17	15	17	19	1,252,844
2028	18	16	18	20	1,282,040
2029	18	16	18	20	1,311,706
2030	19	17	19	21	1,341,877
2031	20	18	20	22	1,372,577
2032	20	18	20	22	1,403,874

# Number of District Courts vs. Number of ALL\* Courts

---

	District Court Judges	Associate Judges	Magistrates	Juvenile Referee	OCA Child Support Courts	OCA CPS Courts	Total Judges	+/- (%More than Collin)
Dallas	39	7	9	3	3	1	62	45 (265%)
Tarrant	28	6	16	2	3	2	57	40 (235%)
Travis	21	4	1			1	27	10 (59%)
Collin	13		3		1		17	
Denton	11	1	7		1		20	3 (18%)

“All Courts” does not include County Courts at Law, Municipal Courts, Justice of the Peace Courts, but those having District Court duties.

# Other Responsibilities

---

Specialty Courts – Help Dispose of Cases through something other than trial process

- CPS/Drug Court – Helps individuals with drug issues become better parents
- Drug Court – Intensive help to break the cycle of addiction
- GEMS Court – Helps vulnerable Juveniles avoid addiction and being sexually trafficked
- Veterans Court – provides intensive supervision for those who have honorably served
- Mental Health Court – NEW – Grant funded to provide supervision for those with MH/MR issues

Various County Boards and Oversight

Public Service Events and Involvement

Warrants and pre-case issues

State wide committees and judicial groups

Civic and Educational Responsibilities

Meetings with County Partners

# Trust Us, We're the Experts

---

## Serving on State and National Boards

- National Center for State Courts – Director
- Texas Supreme Court Advisory Committee
- Board of Directors – Texas Center for the Judiciary (TJC)
- State Bar of Texas – Jury Charge Oversight Committee
- State Bar of Texas - Computer and Technology Section Council Member
- State Bar of Texas - Jury Services Committee
- State Bar of Texas – Military and Veterans Law Section Council Member
- Supreme Court of Texas Remote Proceedings Task Force
- Judicial Committee on Information Technology
- Texas Supreme Court Judicial Advisory Council (JAC)
- Texas Board of Legal Specialization Child Welfare Advisory Commission
- Children's Justice Act Task Force
- Governor's Specialty Courts Advisory Committee
- Texas Children's Commission
- American Judges Association – Criminal and Juvenile Justice, Public Relations Committees
- Texas Judicial Commission on Mental Health
- Chair of TJC – Curriculum Committee

Where do we  
go from here?

Estimates for Collin County 2050 vary wildly from 1.8 million in some reports to 3.8 million in others.

Workload and weighted case studies are planned by OCA in 2023. These studies will likely show that as we grow, cases become more complex and the length of time to resolution is increasing.

The Collin County District Judges  
request a vote,  
by the Honorable Commissioners' Court of Collin County,  
in favor of the 88<sup>th</sup> Legislature  
adding two (2) new general jurisdiction district courts  
in and for Collin County.

Questions?

---



Public service must be more than doing a job efficiently and honestly. It must be a complete dedication to the people and to the nation **county**.

[Margaret Chase Smith](#)





# Courts Workshop

January 2023



# Index

---

- Existing Space
  - Hearing Rooms (Auxiliary B & C)
  - Auxiliary Courts (A & D)
- Proposal and Economic Environment
  - Master Plan
    - Construction Cost
    - Total Cost
  - Bond to Built Timeline
  - U.S. Market Conditions
  - Local Market Conditions – Collin County’s Experience
- Discussion



## Existing Space

---

- **Court Rooms**
  - 7 County Courts at Law – seat 70; 14 juror seats
  - 13 District Courts – seat 70; 14 juror seats
  - 2 Auxiliary Courts (“Aux A&D”) – seat 70; 14 juror seats
  - 2 Hearing Rooms (“Aux B&C”) – seat 30; no jury box
  - Ceremonial Courtroom- seats 120; 14 juror seats
  - Probate Court – seats 30; 6 juror seats
- **Office Areas**
  - 23 Court suites
  - 2 Hearing Rooms (Auxiliary B & C) and Ceremonial Courtroom share an extended back office area



# Existing Space Hearing Rooms (Auxiliary B & C)

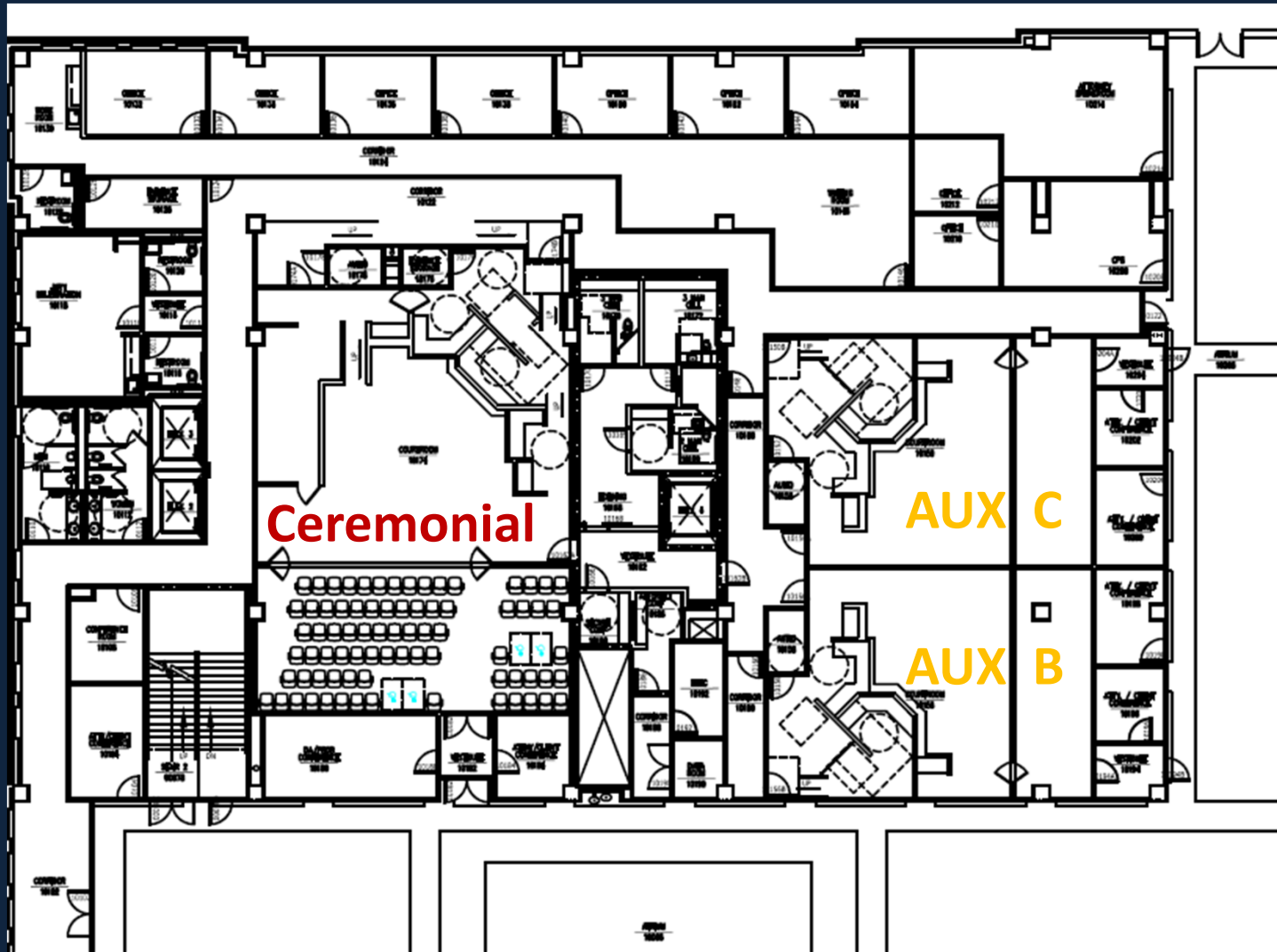

Courthouse  
1<sup>st</sup> Floor



# Existing Space Auxiliary Courts (A & D)

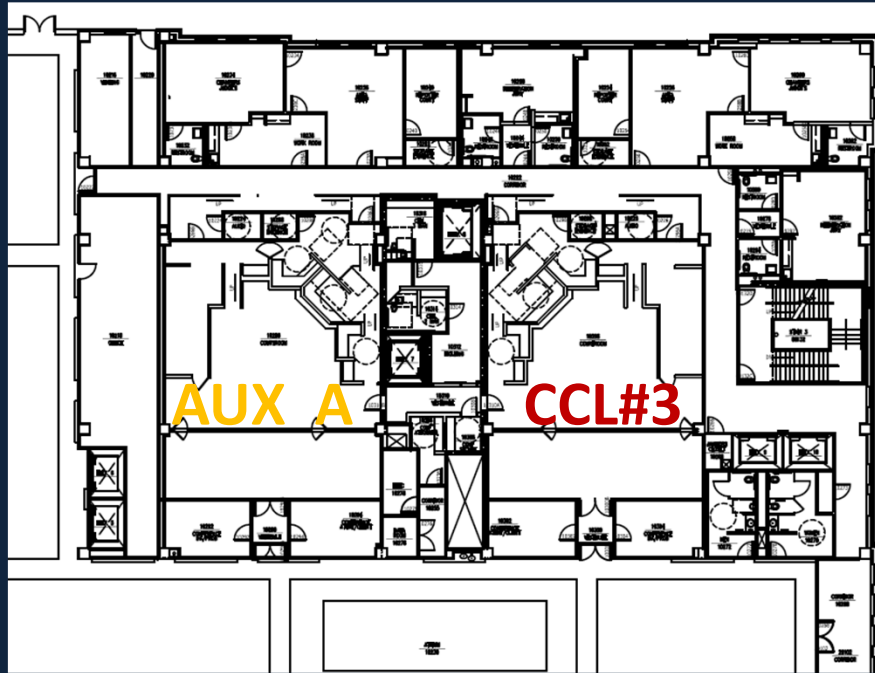

Courthouse  
1<sup>st</sup> Floor

Courthouse  
2<sup>nd</sup> Floor

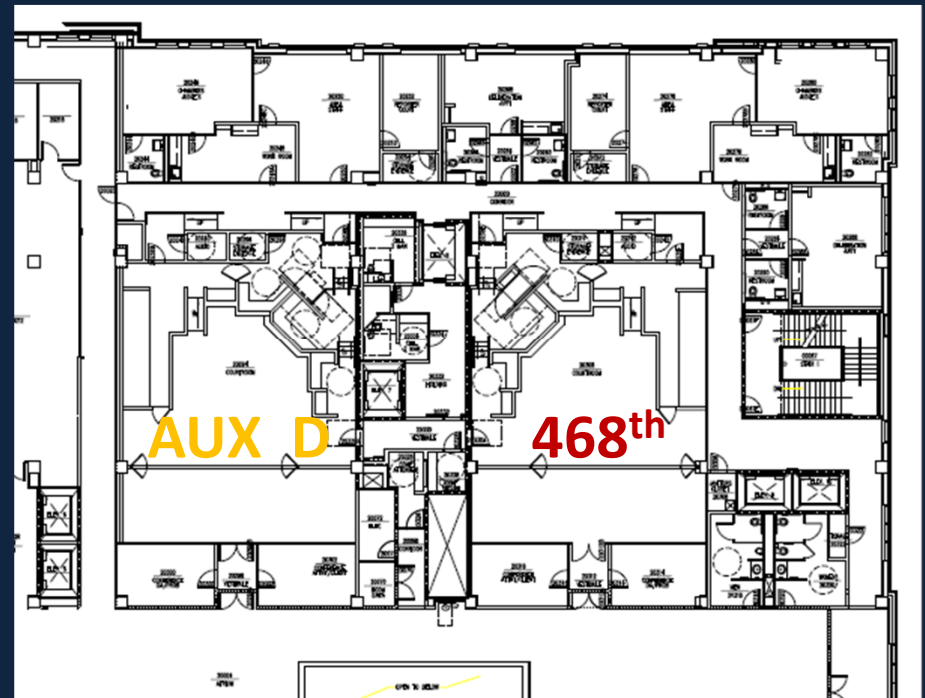



## Master Plan – Construction Cost

Twelve (12) Courtroom Addition	\$74,550,000
Office Suite Addition	\$49,700,000
Parking Garage	\$20,000,000
Sky Bridge	<u>\$3,000,000</u>
Total	\$176,700,000

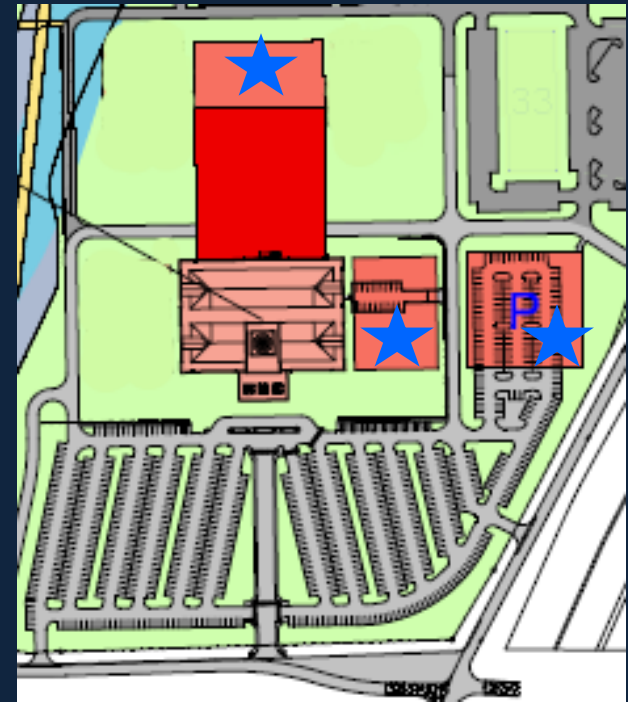



## Master Plan – Total Cost

- **Construction Costs - \$176,700,000**
- **District Court - \$727,000**
  - Personnel - \$374,000 (4 positions)
  - One-Time Purchases - \$338,000
  - Recurring Training/Travel and Maintenance/Operations - \$15,000
- **District Attorney - \$533,000**
  - Personnel - \$451,000 (4 positions)
  - One-Time Purchases - \$61,000
  - Recurring Training/Travel and Maintenance/Operations - \$21,000
- **District Clerk - \$234,000**
  - Personnel - \$196,000 (3 positions)
  - One-Time Purchases - \$35,000
  - Recurring Training/Travel and Maintenance/Operations - \$3,000

Note: One-Time Purchases for the District Court include Judges Chambers, Reception Area, Breakroom, Courtroom, Jury Room and 2 Witness Rooms.



# Bond to Built Timeline

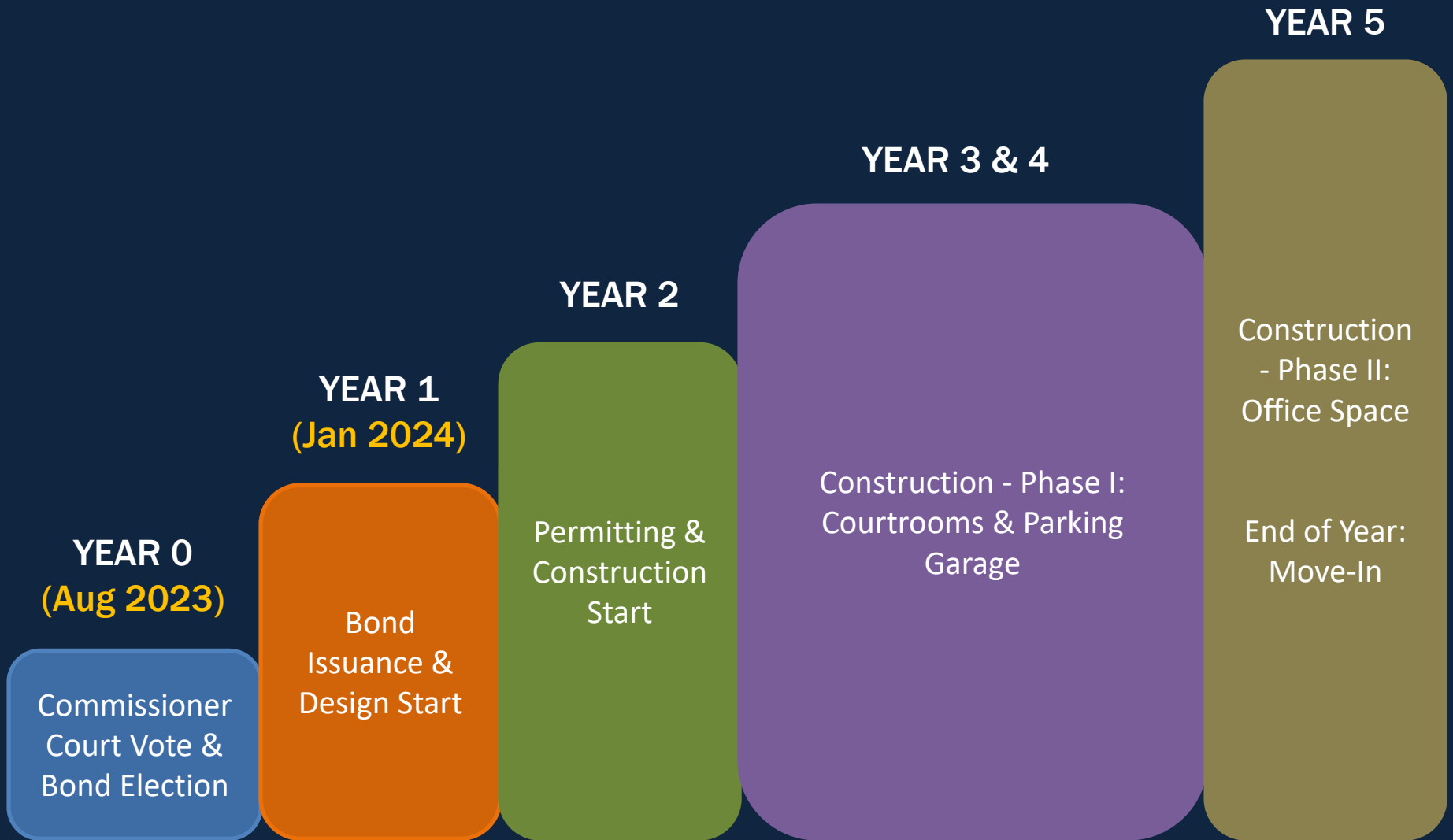





## U.S. Market Conditions

- **Materials**
  - Producer Price Index (“PPI”), Concrete Contractors, Non-Res Building – 30 year average inflation rate was 3.7% per year
    - **YTD November 2022, it is 23.3%**
  - PPI, Concrete products alone have **increased 22.7% over last 2 years**
  - Steel is roughly **2 times the price it was in January 2021**
- CBRE’s Construction Cost Index says the price paid for goods and services on new nonresidential construction **jumped 42% between March 2020 and March 2022**
- On top of skyrocketing material costs and supply chain shortages, **construction wages and distribution logistics costs have all amplified** as well
- With on-going investments in public sector infrastructure fueled by \$350B in ARPA funds and \$110B from the Bipartisan Infrastructure Law, **construction costs are expected to continue to inflate**

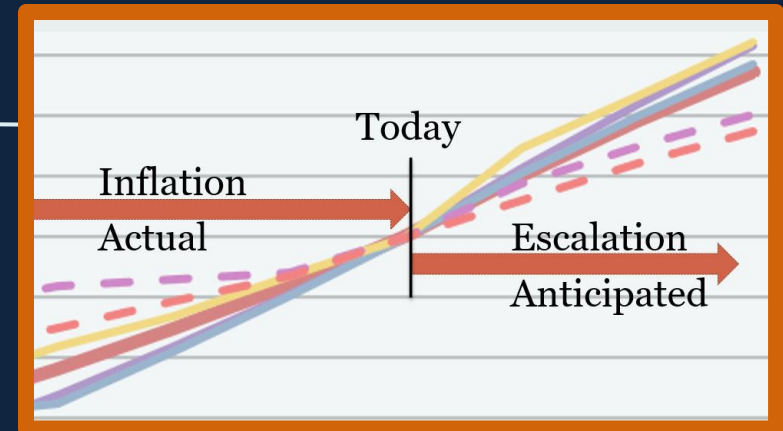

**Deflation is not likely. Only twice in 50 years has the U.S. experienced a construction cost deflation, the recession years of 2009 and 2010.**



# Local Market Conditions – Collin County’s Experience

Collin County’s experience in recent bidding efforts on existing projects:

- Central Plant - \$16m budget (Apr 2021)
  - 50% estimate - \$20.5m (Jun 2022)
  - Bid result - \$25.5m (Dec 2022)
- ADC Infirmery - \$76m budget (Apr 2021)
  - SD Estimate \$93.3m (Jul 2022) = \$490/sf
  - Design Doc Estimate \$97.9m (Dec 2022) = \$515/sf
- **24.7% increase in cost per square foot from Dec 2020 when the ADC Book-In building was estimated**

## Dec 2021 to July 2022 Actuals

Concrete – 58% ↑  
Masonry – 103% ↑  
MEP – 65% ↑  
Detention Equip – 18% ↑  
Security Tech – 38% ↑

**24.7%**

## Resource Availability

With tight U.S. Treasury deadlines through 2026, ARPA projects are constraining county resources across IT, Facilities, Purchasing and Construction Departments

**Collin County**  
**2018 Bond Authorization Implementation and Future Debt Capacity Analysis**

A	B	C	D	E	F	G	H	I	J	K	L	M	N	O
FYE	Freeze Adj Net Taxable Assessed Valuation <sup>(1)</sup>	Growth Rate	Current Outstanding Debt Service <sup>(2)</sup>	Existing Debt Projected Tax Rate <sup>(3)</sup>	2018 Authorization	Potential New Bond Authorization (6 Year Capacity) - \$627,920,000						Projected Grand Total Net Debt Service	Projected I&S Tax Rate <sup>(3)</sup>	
					Series 2023 \$266,445,000 6/15/2023 - 4.50% Proj D/S	Series 2024 \$271,950,000 6/15/2024 - 5.00% Proj D/S	Series 2025 \$89,960,000 6/15/2025 - 5.00% Proj D/S	Series 2026 \$81,175,000 6/15/2026 - 5.00% Proj D/S	Series 2027 \$70,705,000 6/15/2027 - 5.00% Proj D/S	Series 2028 \$74,910,000 6/15/2028 - 5.00% Proj D/S	Series 2029 \$39,220,000 6/15/2029 - 5.00% Proj D/S			\$627,920,000 Total Debt Service
2023	192,741,380,440	16.44%	84,681,000	0.04427									84,681,000	0.04427
2024	201,414,742,560	4.50%	55,422,329	0.02752	33,745,875								89,168,204	0.04427
2025	210,478,405,975	4.50%	51,296,845	0.02437	20,198,500	21,684,500						21,684,500	93,179,845	0.04427
2026	216,792,758,154	3.00%	46,922,354	0.02164	20,197,750	21,684,000	7,173,292					28,857,292	95,977,396	0.04427
2027	223,296,540,899	3.00%	43,328,135	0.01940	20,200,875	21,683,000	7,173,125	6,470,708				35,326,833	98,855,843	0.04427
2028	229,995,437,126	3.00%	40,658,131	0.01768	20,196,875	21,684,375	7,172,250	6,470,625	5,635,708			40,962,958	101,817,965	0.04427
2029	236,895,300,240	3.00%	37,736,607	0.01593	20,199,625	21,682,000	7,173,875	6,474,000	5,636,875	5,973,625		46,940,375	104,876,607	0.04427
2030	244,002,159,247	3.00%	37,757,799	0.01547	20,197,875	21,684,625	7,172,625	6,470,625	5,637,250	5,974,000	3,126,333	50,065,458	108,021,132	0.04427
2031	251,322,224,024	3.00%	37,778,073	0.01503	20,200,375	21,681,000	7,173,125	6,470,250	5,636,750	5,972,500	3,127,000	50,060,625	108,039,073	0.04299
2032	258,861,890,745	3.00%	35,439,362	0.01369	20,200,750	21,684,750	7,170,000	6,472,375	5,640,000	5,974,750	3,128,375	50,070,250	105,710,362	0.04084
2033	266,627,747,467	3.00%	33,231,491	0.01246	20,197,750	21,684,375	7,172,750	6,471,625	5,636,750	5,970,500	3,126,500	50,062,500	103,491,741	0.03882
2034	274,626,579,891	3.00%	31,379,425	0.01143	20,199,875	21,683,500	7,170,875	6,472,625	5,636,750	5,974,375	3,126,250	50,064,375	101,643,675	0.03701
2035	282,865,377,288	3.00%	29,357,453	0.01038	20,200,500	21,680,625	7,173,875	6,474,875	5,639,500	5,971,000	3,127,375	50,067,250	99,625,203	0.03522
2036	291,351,338,607	3.00%	26,597,869	0.00913	20,198,125	21,684,000	7,171,250	6,473,000	5,639,625	5,975,000	3,129,625	50,072,500	96,868,494	0.03325
2037	300,091,878,765	3.00%	26,445,838	0.00881	20,201,000	21,681,875	7,172,500	6,471,625	5,636,875	5,971,000	3,127,875	50,061,750	96,708,588	0.03223
2038	309,094,635,128	3.00%	26,441,134	0.00855	20,197,375	21,682,500	7,172,000	6,470,250	5,635,875	5,973,625	3,127,000	50,061,250	96,699,759	0.03128
2039	318,367,474,182	3.00%	26,448,675	0.00831	20,200,375	21,683,875	7,174,125	6,473,250	5,636,125	5,972,375	3,126,750	50,066,500	96,715,550	0.03038
2040	327,918,498,407	3.00%	17,919,244	0.00546	20,198,000	21,684,000	7,173,250	6,475,000	5,637,125	5,971,875	3,126,875	50,068,125	88,185,369	0.02689
2041	337,756,053,359	3.00%	8,879,550	0.00263	20,198,250	21,680,875	7,173,750	6,475,000	5,638,375	5,971,625	3,127,125	50,066,750	79,144,550	0.02343
2042	347,888,734,960	3.00%	4,064,700	0.00117	20,198,875	21,682,250	7,174,875	6,472,750	5,639,375	5,971,125	3,127,250	50,067,625	74,331,200	0.02137
2043	358,325,397,009	3.00%			20,197,625	21,680,750	7,171,000	6,472,625	5,639,625	5,974,750	3,127,000	50,065,750	70,263,375	0.01961
2044	369,075,158,919	3.00%				21,683,875	7,171,375	6,473,875	5,638,625	5,972,000	3,126,125	50,065,875	50,065,875	0.01357
2045	380,147,413,687	3.00%					7,175,000	6,470,875	5,635,875	5,972,375	3,129,250	28,383,375	28,383,375	0.00747
2046	391,551,836,097	3.00%						6,472,875	5,635,750	5,970,250	3,126,125	21,205,000	21,205,000	0.00542
2047	403,298,391,180	3.00%							5,637,500	5,974,875	3,126,500	14,738,875	14,738,875	0.00365
2048	415,397,342,916	3.00%								5,970,625	3,125,000	9,095,625	9,095,625	0.00219
2049	427,859,263,203	3.00%									3,126,250	3,126,250	3,126,250	0.00073
Totals:			\$ 701,786,014		\$ 417,526,250	\$ 433,660,750	\$ 143,454,917	\$ 129,448,833	\$ 112,750,333	\$ 119,452,250	\$ 62,540,583	\$ 1,001,307,667	\$ 2,120,619,931	

(1) FYE 2023 is the Freeze Adjusted Net Taxable Value provided by the County; **Projected** Growth Rates as provided by County Officials.  
(2) "Current Outstanding Debt Service" includes both Unlimited and Limited Tax Debt.  
(3) Assumes 100% collection rate; FY 2023 tax rate is actual.

**From:** Monika Arris <[marris@co.collin.tx.us](mailto:marris@co.collin.tx.us)>  
**Sent:** Tuesday, January 3, 2023 4:42 PM  
**To:** Bill Bilyeu <[bbilyeu@co.collin.tx.us](mailto:bbilyeu@co.collin.tx.us)>  
**Cc:** Nicole Gillespie <[ngillespie@co.collin.tx.us](mailto:ngillespie@co.collin.tx.us)>  
**Subject:** Tax Rate Analysis "eye-chart"

Bill,

Attached is the tax rate analysis with the assumptions of selling all of the remaining authorization in 2023. 2024-2029 is the maximum capacity the county can sell with a level debt payment and maintaining the current debt tax rate of \$0.04427. I used 4.5% growth factor for the next two years and then dropped to 3% thereafter. Over the past ten years we have had an total value increase of 3% or higher. New construction has held a steady increase in the 3%-4% range so I am comfortable with the projected growth used in the analysis.

FISCAL YEAR	TAX YEAR	Adj Taxable Value % Change	% Increase due to New Value
2013	2012	3.00%	1.72%
2014	2013	6.16%	2.21%
2015	2014	9.31%	3.02%
2016	2015	11.23%	3.19%
2017	2016	12.59%	3.50%
2018	2017	13.74%	4.57%
2019	2018	11.51%	4.48%
2020	2019	7.93%	3.80%
2021	2020	4.45%	3.37%
2022	2021	7.13%	3.25%
2023	2022	17.31%	3.82%

Regards,

**Mónika Arris, CGFO, CIO**  
Director of Budget & Finance  
**Collin County**  
Office: 972-548-4603  
Cell: 214-686-7242  
Fax: 214-491-4828  
[MArris@collincountytx.gov](mailto:MArris@collincountytx.gov)