

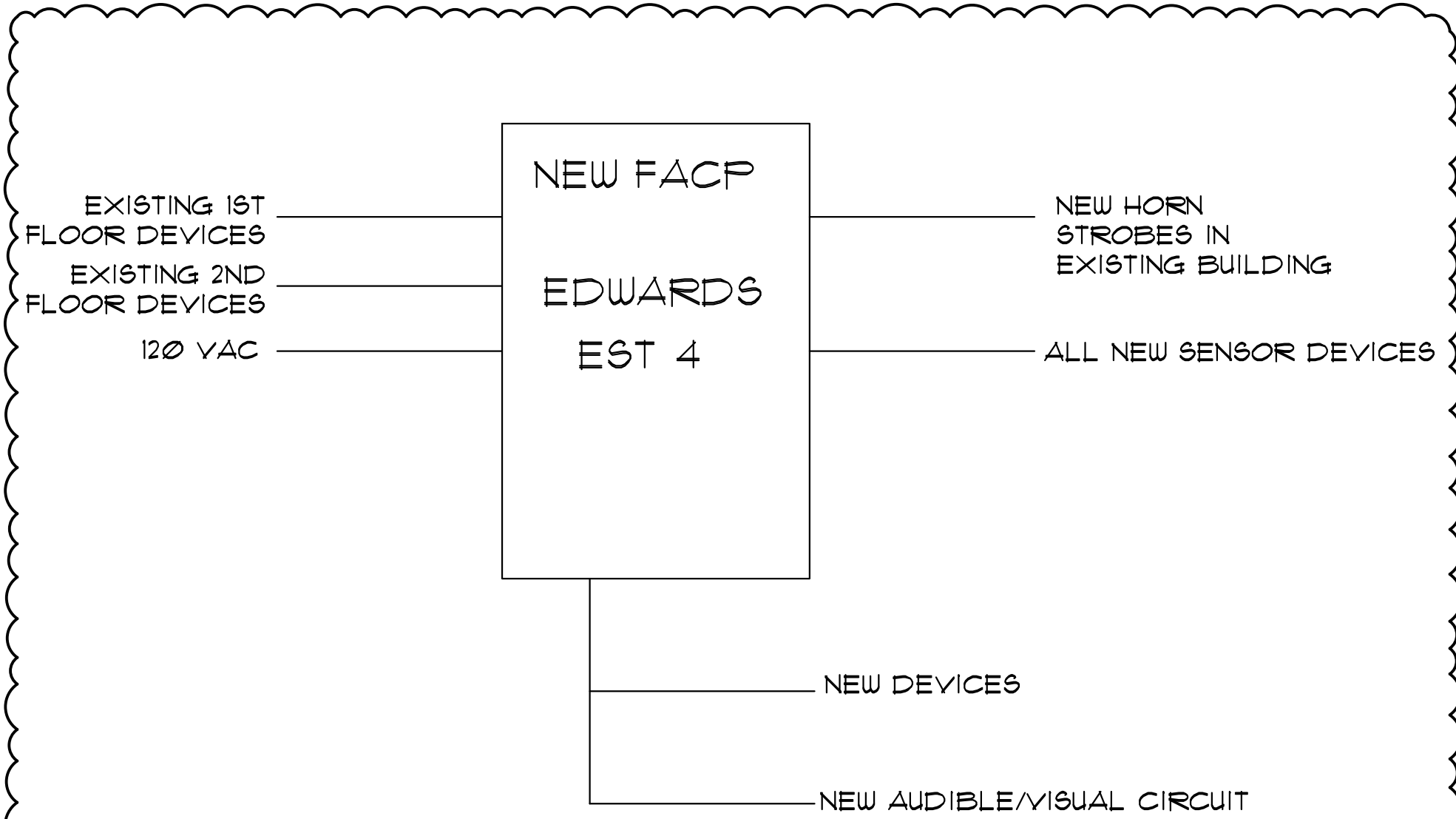

EXISTING FACP IS EDWARDS EST 3.
EXISTING FACP TO BE UPGRADED TO
EDWARDS EST 4. RECONNECT EXISTING FA
DEVICES INTO NEW FACP.

1

1 EXISTING FIRE ALARM PANEL
SCALE: 1/4"=1'-0"



1 FIRE ALARM DETAIL
SCALE: NTS

1

FIRE ALARM / DEVICE SCHEDULE - NEW

FACP: DIGITAL ADDRESSABLE TYPE CAPABLE OF A MINIMUM 198 DEVICES. MICROPROCESSOR BASED CONTROL. 4x40 ALPHANUMERIC DISPLAY. AUTOMATIC DRIFT COMPENSATION. ADJUSTABLE SENSOR SENSITIVITY. ONE MAN WALK TEST. UP/DOWNLOAD PC COMPATIBLE. 1000 EVENT HISTORY LOGGING. POSITIVE ALARM SEQUENCE. CODED SIGNALING. NETWORKABLE. ADA IN-RUSH TOLERANT SIGNAL CIRCUITS. ALARM VERIFICATION. SIGNAL SILENCE INHIBIT. LCD PROMPTED OPERATION AND PROGRAMMING. DEFAULT ALARM MODE. POWER LIMITED 10 CIRCUITS. INCLUDE NECESSARY RELAY OUTPUT MODULES AND SIGNAL NOTIFICATION CONTROL PANELS. PROVIDE WITH BATTERY BACKUP. SIZED ACCORDING TO NFPA BATTERY CALCULATIONS, SEALED LEAD ACID TYPE WITH CABINET. REWORK 120V AC POWER FROM OLD PANEL TO NEW. TEST AND VERIFY ALL OPERATIONS. COORDINATE ALL REQUIRED APPROVALS WITH LOCAL AUTHORITIES. PROVIDE ALL PROGRAMMING, STARTUP, AND OWNER TRAINING. REFERENCE EDWARDS EST 4.

COMMUNICATION: IN ACCORDANCE WITH LOCAL REGULATIONS, THE NEW FACP SHALL HAVE ANY APPROPRIATE COMMUNICATION MODULE, SATISFYING ALL CITY REQUIREMENTS. ARRANGE AND CONNECT COMMUNICATION, COMPLETE AND READY TO USE. CONTRACTOR SHALL PAY ALL FEES ASSOCIATED WITH ESTABLISHING COMMUNICATION.

ANNUNCIATOR: LCD REMOTE. INCLUDE REMOTE ACKNOWLEDGE, RESET, SIGNAL SILENCE, DISPLAY FIRST EVENT, DISPLAY NEXT EVENT, DISPLAY PREVIOUS EVENT, HOLD EVENT. FIELD PROGRAMMABLE. RS232 OUTPUTS. MICROPROCESSOR BASED. FULLY SUPERVISED. SEMI FLUSH WALL MOUNTING WITH BACK BOX. REFERENCE EDWARDS EST 4.

ADDRESSABLE DETECTORS: REFERENCE EDWARDS EST 4.

ADDRESSABLE MANUAL PULL STATIONS WITH PLASTIC ALARM COVERS: REFERENCE EDWARDS EST 4

AUDIO-VISUAL DEVICES: ADA COMPLIANT. CONTRACTOR TO FIELD EVALUATE, SELECT CANDELA AND DECIBEL AS APPROPRIATE. REFERENCE EDWARDS EST 4

PID DEVICES: INCLUDE AS REQUIRED, INCLUDING AN ADDRESSABLE DEVICE WHICH WILL REGISTER A TROUBLE SIGNAL TO THE FACP IF THE UPS EPO SWITCH IS CLOSED.

OTHER DEVICES: AS INDICATED BY PLANS, REFERENCE EDWARDS EST 4

1

FIRE PROTECTION SCOPE OF WORK-EXISTING

THE FIRE PROTECTION SYSTEM WORK SHALL BE DESIGN BUILD. THE CONTRACTOR SHALL PROVIDE ALL NECESSARY LABOR, MATERIALS, DESIGN, CALCULATIONS AND COORDINATE WITH ALL LOCAL AUTHORITIES HAVING JURISDICTION TO PRODUCE A COMPLETE AND USABLE SYSTEM WHICH COMPLIES WITH ALL APPLICABLE CODES, LAWS AND REGULATIONS INCLUDING NFPA13 AND THE LOCAL BUILDING CODE. COORDINATE ALL INSTALLATIONS WITH THE GC AND OTHER TRADES TO AVOID CONFLICTS. THE FP SUBCONTRACTOR SHALL BE OBLIGATED TO RELOCATE/REDESIGN ANY PIPE WHICH COME INTO CONFLICT WITH OTHER TRADES AT NO ADDITIONAL COST TO THE OWNER, UNDER ALL CIRCUMSTANCES.

SYSTEM TYPE: WET PIPE WATER SPRINKLER, NFPA 13. MODIFY EXISTING SYSTEMS TO ACCOMMODATE THE NEW INSTALLATION.

WATER SERVICE/RISER: EXISTING TO REMAIN

DESIGN: THE DESIGN BUILD CONTRACTOR SHALL BE SOLELY RESPONSIBLE FOR THE SURVEY OF EXISTING, FLOW TEST, DESIGN, CALCULATIONS, DETAILING, SUBMITTAL, APPROVAL, COORDINATION, LABOR MATERIAL, TESTING AND FINAL PRODUCT. IF REQUIRED, THE CONTRACTOR SHALL INCLUDE ANY REQUIRED FLOW TEST. IF NECESSARY, REPLACEMENT OR AUGMENTATION OF THE RPZ BACK FLOW PREVENTER SHALL BE INCLUDED (DOUBLE DETECTOR CHECK WILL NOT BE ACCEPTABLE). THE EXISTING BACK FLOW PREVENTER MAY BE RETAINED ONLY IF CALCULATIONS DOCUMENT AND CONFIRM CAPACITY IS ADEQUATE. CONTRACTOR SHALL RELOCATE HEADS IN THE EXISTING SUITE AS NEEDED FOR DESIGN/COVERAGE.

MATERIALS: PIPE SHALL BE BLACK STEEL. 2" AND SMALLER SHALL BE SCH40 WITH THREADED FITTINGS. 2-1/2" AND LARGER MAY BE SCH10 WITH MECHANICAL COUPLINGS OR BUTT WELD FITTINGS.

HEADS: SHALL BE CONCEALED TYPE. HEADS DO NOT HAVE TO BE CENTERED IN TILE.

FIRE ALARM REQUIREMENTS-NEW

EC SHALL CONNECT ALL NEW FIRE ALARM DEVICES TO NEW SCHEDULED FACP. EC SHALL DESIGN, DETAIL, AND FURNISH A COMPLETE AND USABLE FIRE ALARM SYSTEM THAT COMPLIES WITH ALL LOCAL AND NATIONAL CODES. NEW REMOTE DEVICES SHALL INCLUDE HORN STROBE UNITS, FULL STATIONS, ZONE IDENTIFICATION DEVICES, AND SMOKE DETECTORS. ALL NEW DEVICES SHALL BE ADDRESSABLE AND FULLY COMPATIBLE WITH NEW SYSTEM. FA CONTRACTOR SHALL ALLOW FOR UP TO 15 ADDITIONAL REMOTE DEVICES FROM THAT SHOWN OR DESCRIBED BY THESE DOCUMENTS. IF ADDITIONAL DEVICES ARE REQUIRED BY AUTHORITY HAVING JURISDICTION THE AFOREMENTIONED DEVICES SHALL BE INSTALLED AT NO ADDITIONAL CHARGE. WIRING SHALL BE PLENUM CABLE TYPE, WITH EMT CONDUIT IN CONCEALED LOCATIONS SUCH AS WALL CAVITIES, OR ANY SURFACE MOUNTED (EXPOSED) DEVICES BELOW 10' AFF. EC SHALL PREPARE AND SEE TO APPROVAL ALL SUBMISSIONS BY AUTHORITY HAVING JURISDICTION. THIS INCLUDES BUT IS NOT LIMITED TO SHOP DRAWINGS, BATTERY CALCULATIONS, CUT SHEETS, ETC. RECONNECT SUPERVISORY SERVICE AS REQUIRED BY AUTHORITY HAVING JURISDICTION. (FEES TO BE SUBMITTED AND PAID BY OWNER)

1

Root
Engineering
Services

Mechanical Electrical & Plumbing Systems Consultant

10411 CORPORATE DR. PLEASANT PRAIRIE, WI 53156

PHONE 847-249-0396 FAX 847-775-1603

PHONE 847-249-0396 FAX 847-775-1603

PHONE 847-249-0396 FAX 847-775-1603

TEXAS PROFESSIONAL ENGINEERING DESIGN FIRM #12016

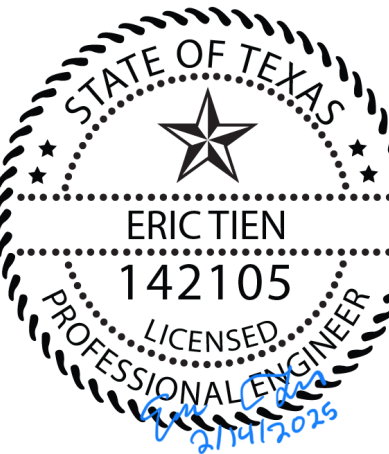

ARCHITECT
SPURGIN
& ASSOCIATES

103 W. LOUISIANA ST

MCKINNEY, TEXAS 75069

972-562-5368

PROJECT
JUVENILE
PROBATION

PARK PLAZA DEVELOPMENT

920 E. PARK BOULEVARD

PLANO, TEXAS 75074

DRAWING ISSUE / REVISION		
Rev. No.	Description	Date
1	FOR PERMIT ADDENDUM 1	09/10/2024 02/14/2025
The Professional seal affixed to this sheet indicates that the named professional has prepared or directed the preparation of the material shown only on this sheet. Other drawings and documents not exhibiting this seal shall not be considered prepared by or the responsibility of the undersigned.		
Copyright © 2024 Root Engineering.		
Drawing Title		
FIRE PROTECTION PLANS		
Drawing No.		
FP2		
Scale		
Dwg By	DJ, ET, FA	Check By
		CB
	Consult Job No.	240002